

YT-1300

LIGHT FREIGHTER

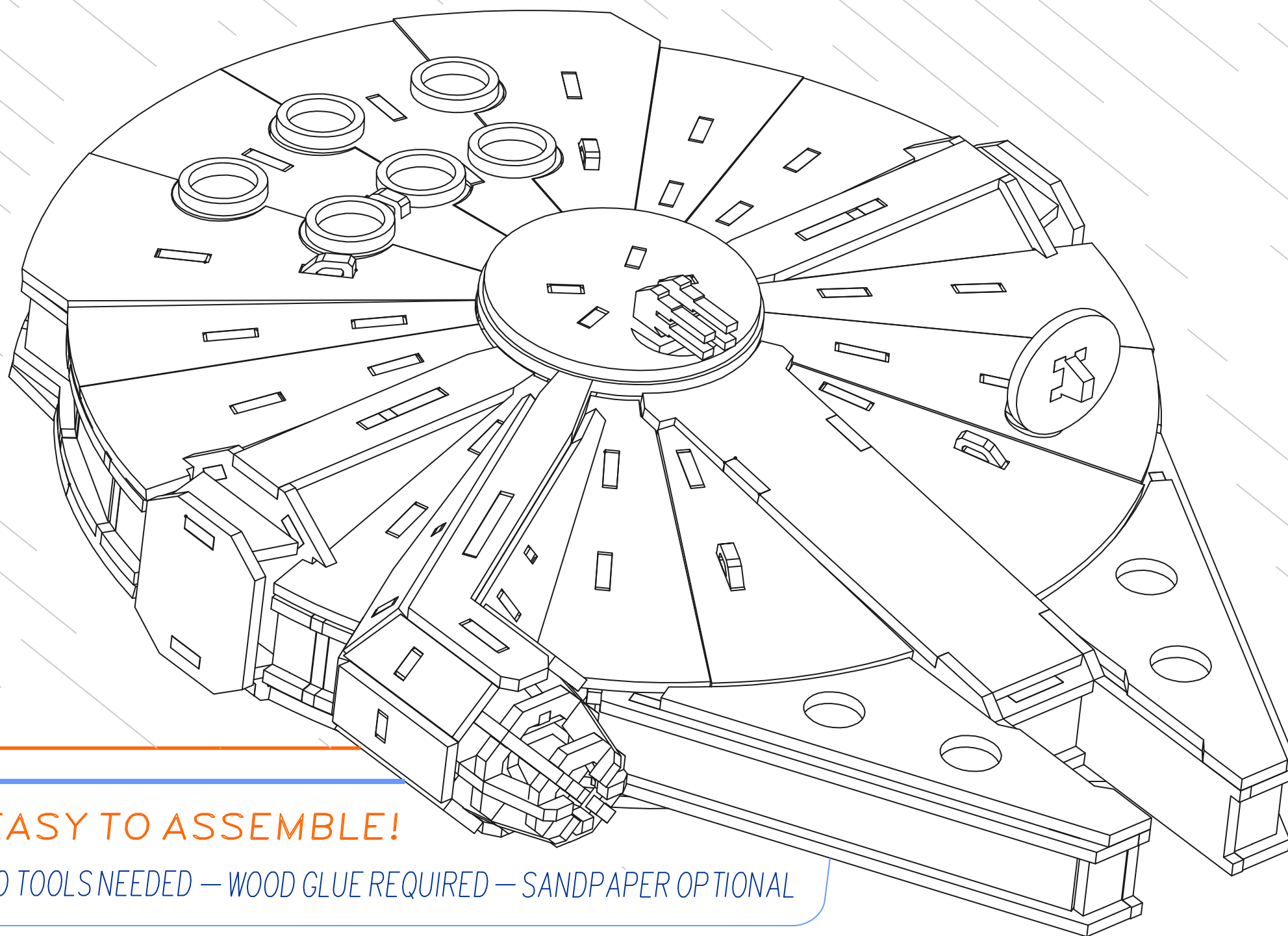
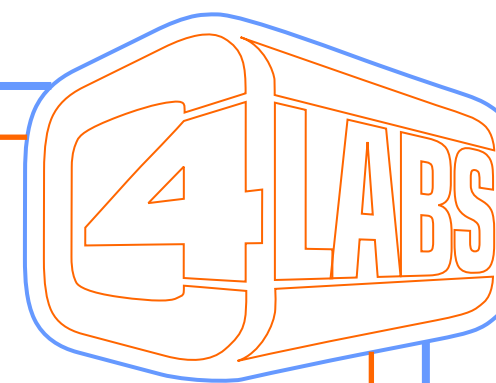

EASY TO ASSEMBLE!

NO TOOLS NEEDED — WOOD GLUE REQUIRED — SANDPAPER OPTIONAL

DESIGN BY BRENT J. ROSENBURGH — C4LABS.NET



NOTES and INSTRUCTIONS

Greetings! This laser-cut model kit was designed to be cut from 1/8th inch medium-density fiberboard (MDF) that measured an actual thickness of 0.13 inches. Since the production processes for different materials often create final thicknesses that vary slightly from their advertised value, measure the material you intend to use with a caliper to get the actual thickness, compare that to 0.13 inches, then scale the cut files to compensate for the difference. If you have 0.125 inch material, then divide 0.125 by 0.13 to get about 0.962. So you would scale the whole document down to 96.2 percent of its size (or by 3.8%) to ensure the tabs fit snugly in the slots.

Since every laser cutter varies in effectiveness, I can not recommend specific values for each color value. For the three colors, configure your project to the settings appropriate for your machine. **Black** line work is intended to be cut through the material. **Blue** lines are a darker etch while **red** lines are lighter.

Lastly, while many parts look identical, each part is unique unless indicated otherwise. I highly recommend removing each part from the material as you assemble to avoid mixing up similar parts. Use a small amount of glue and take your time.

I sincerely hope you enjoy this kit and have a great time!

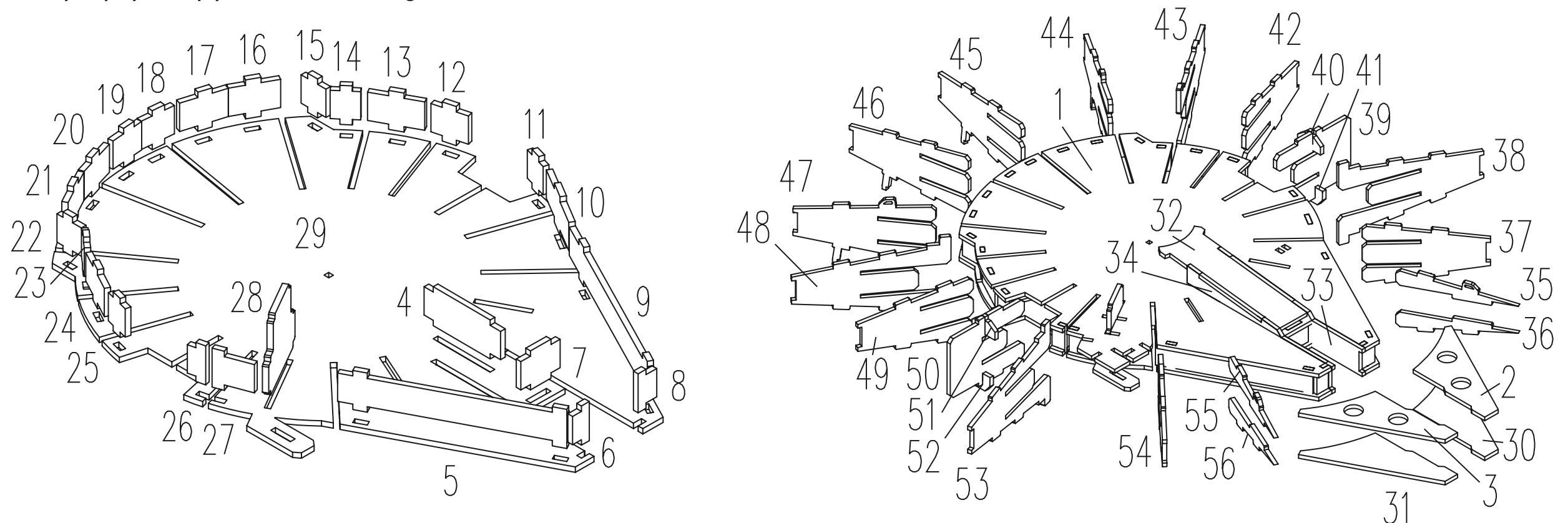

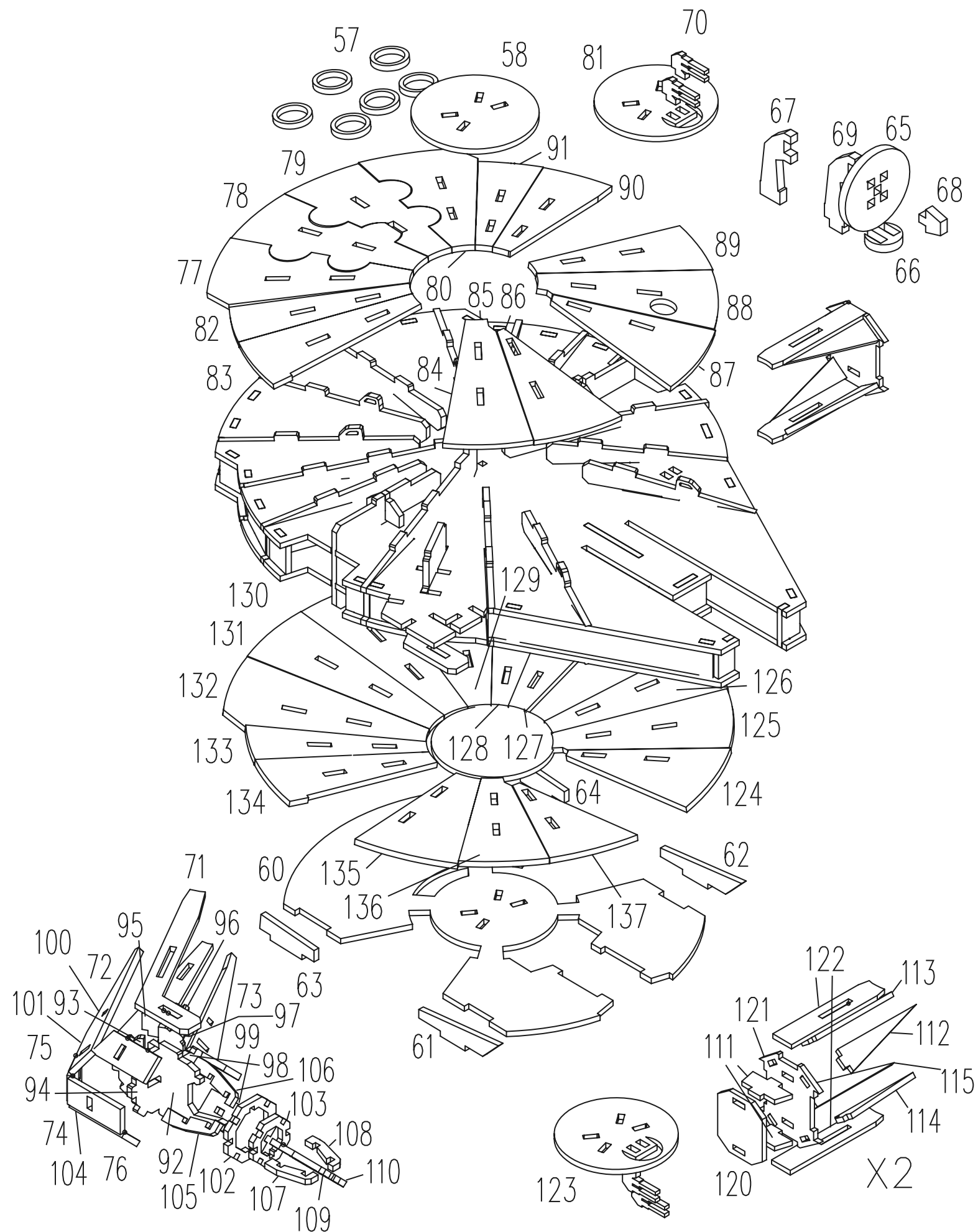

ORNAMENT ASSEMBLY

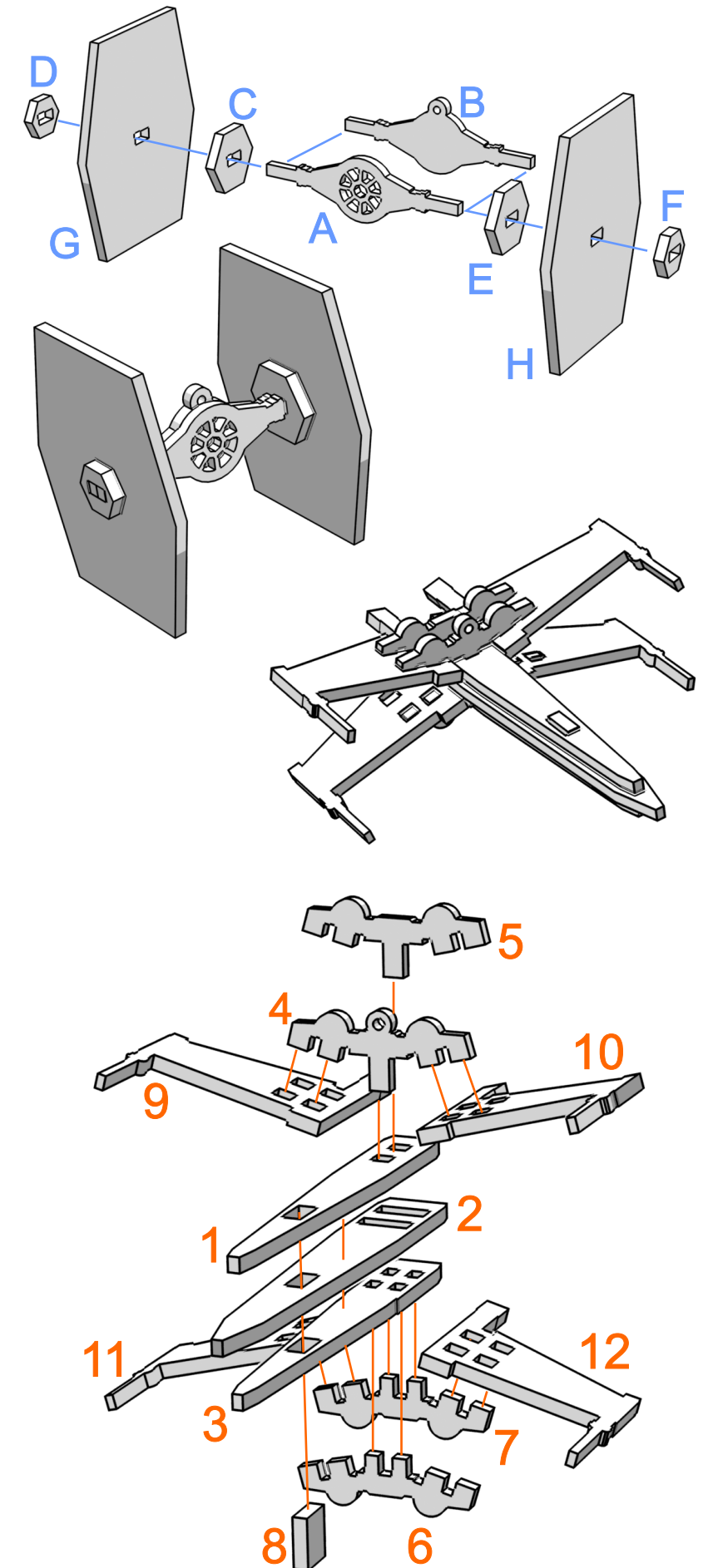

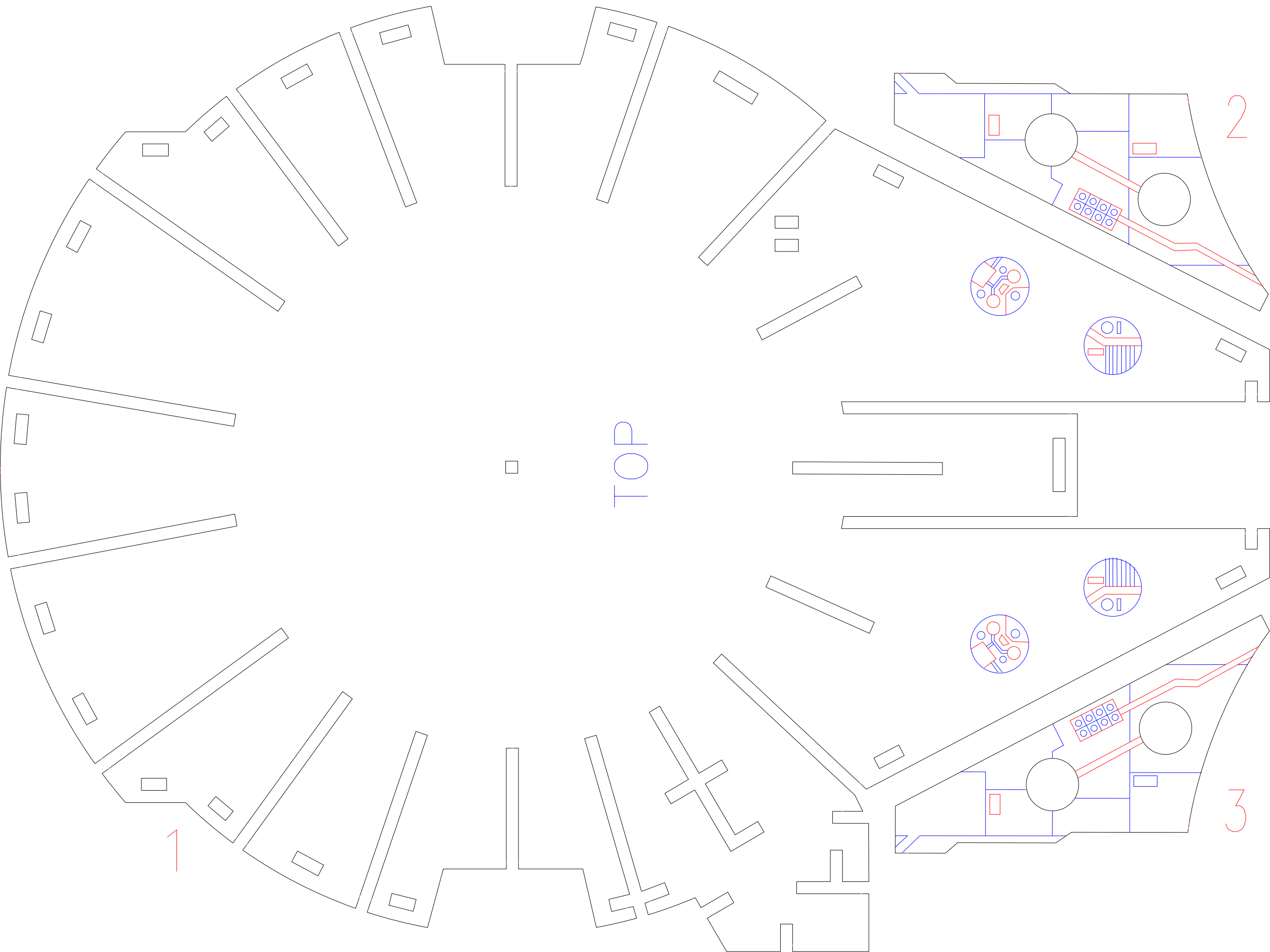

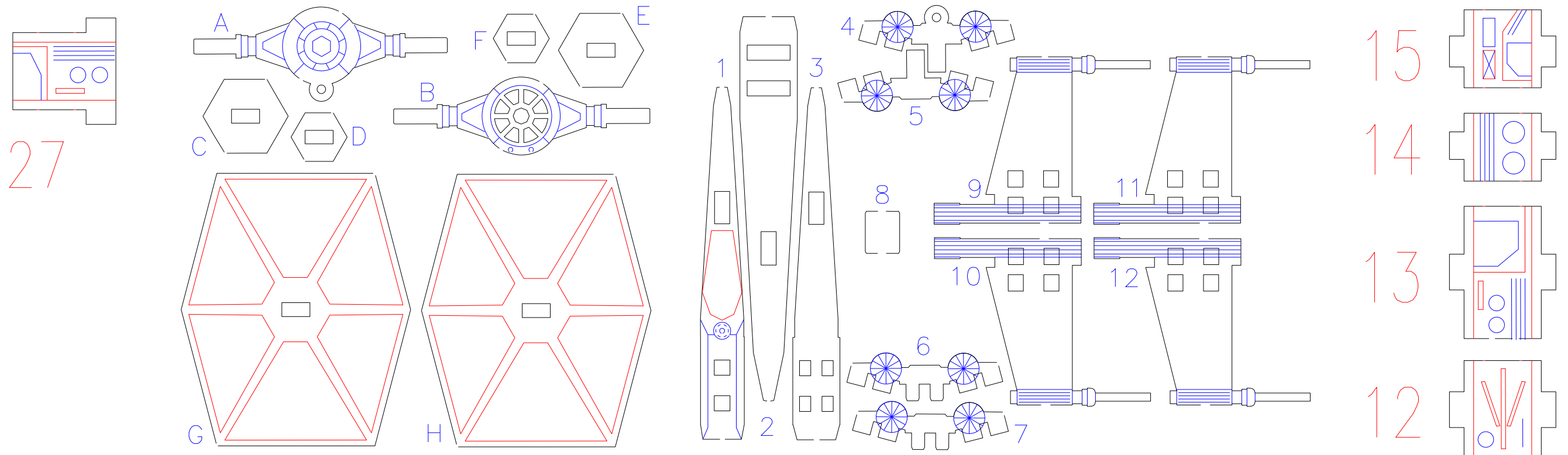
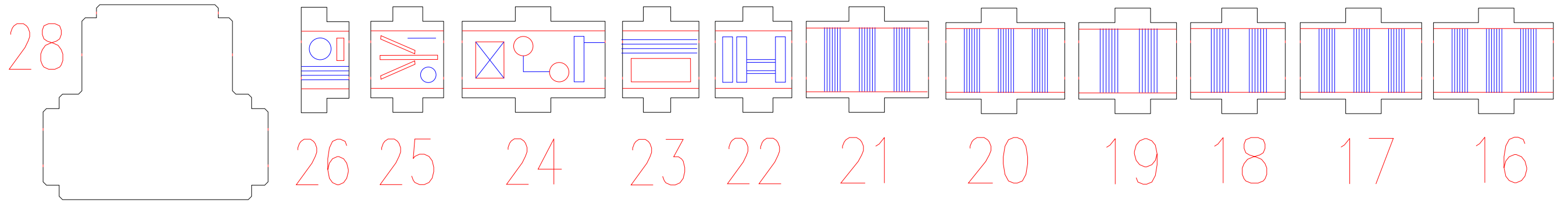

COMPLIMENTARY

YT-1300, TIE FIGHTER and X-WING

HOLIDAY ORNAMENT SET

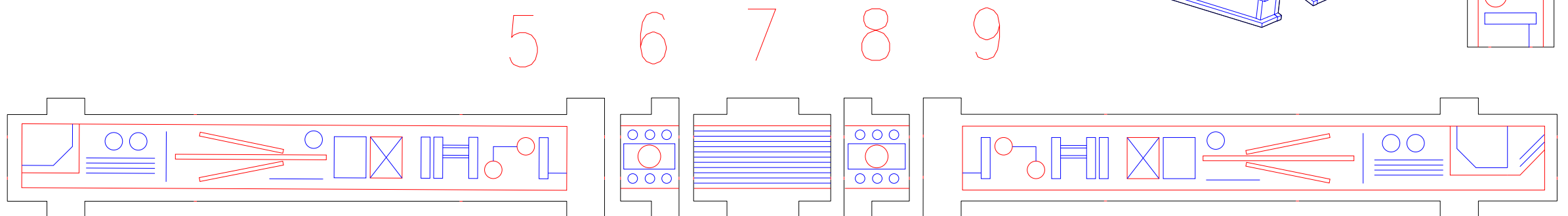
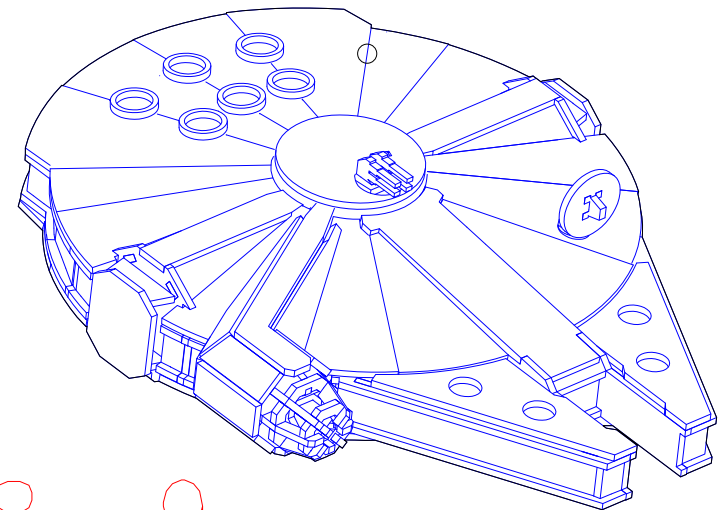
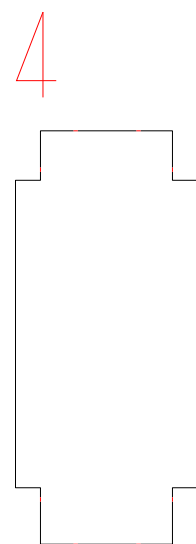

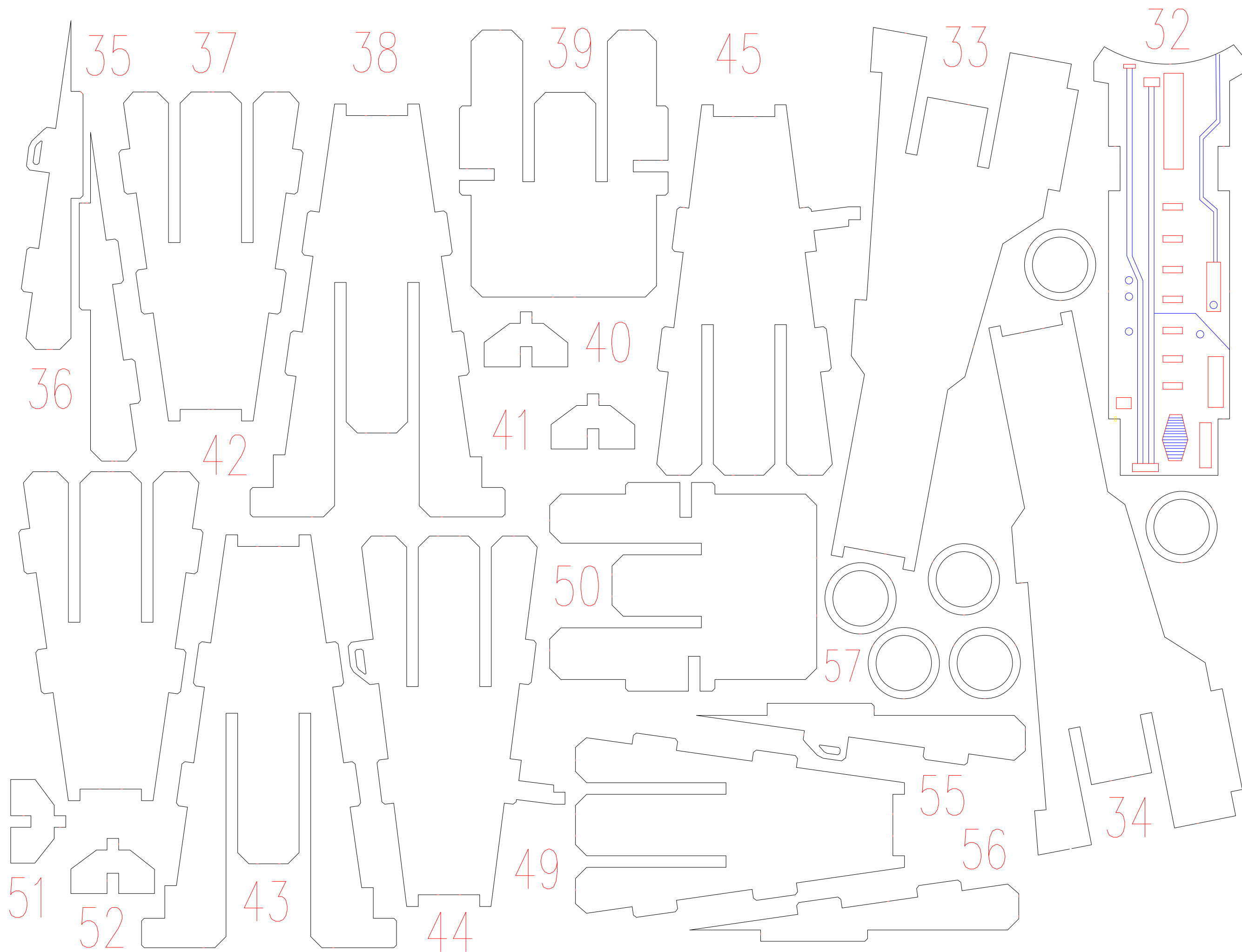

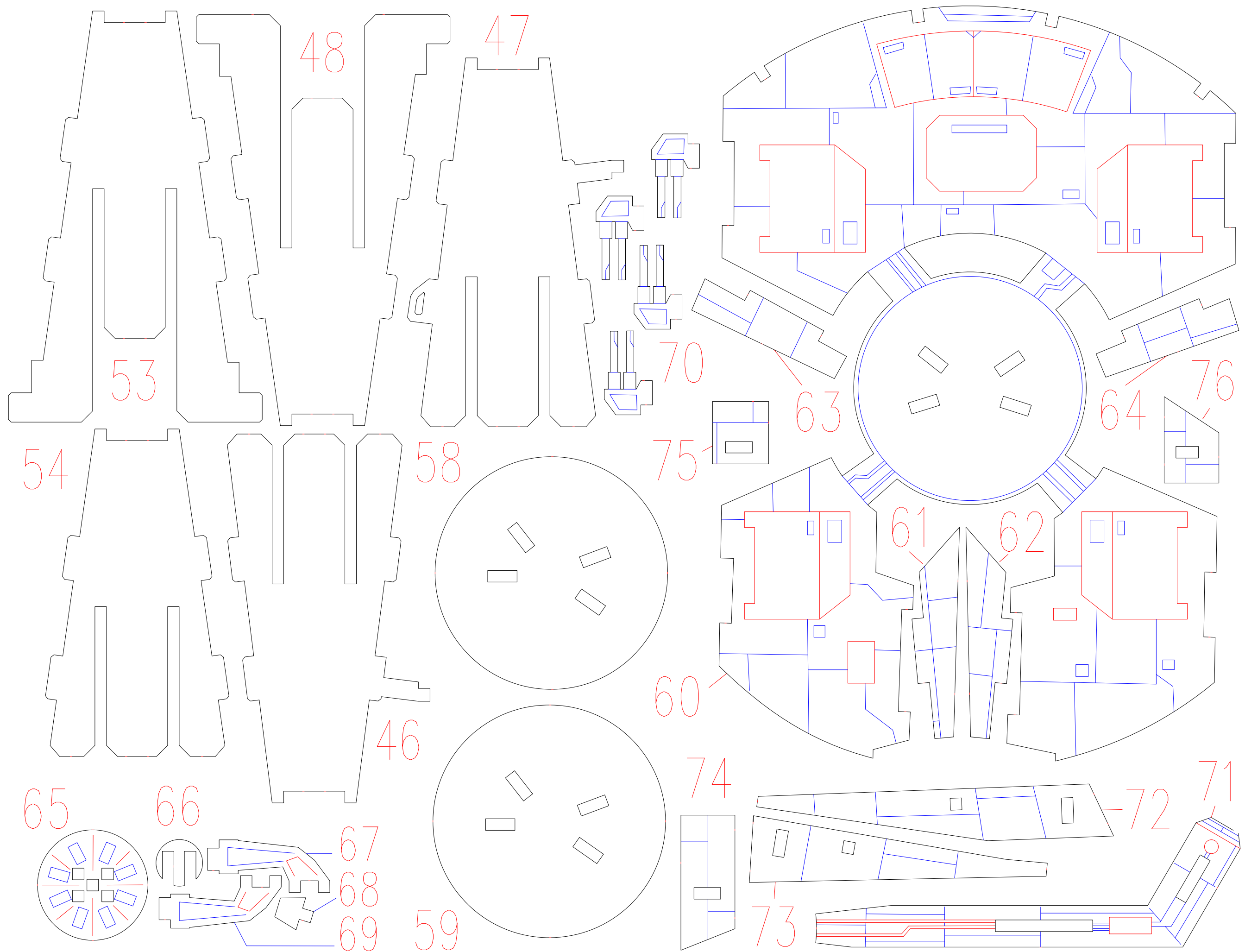

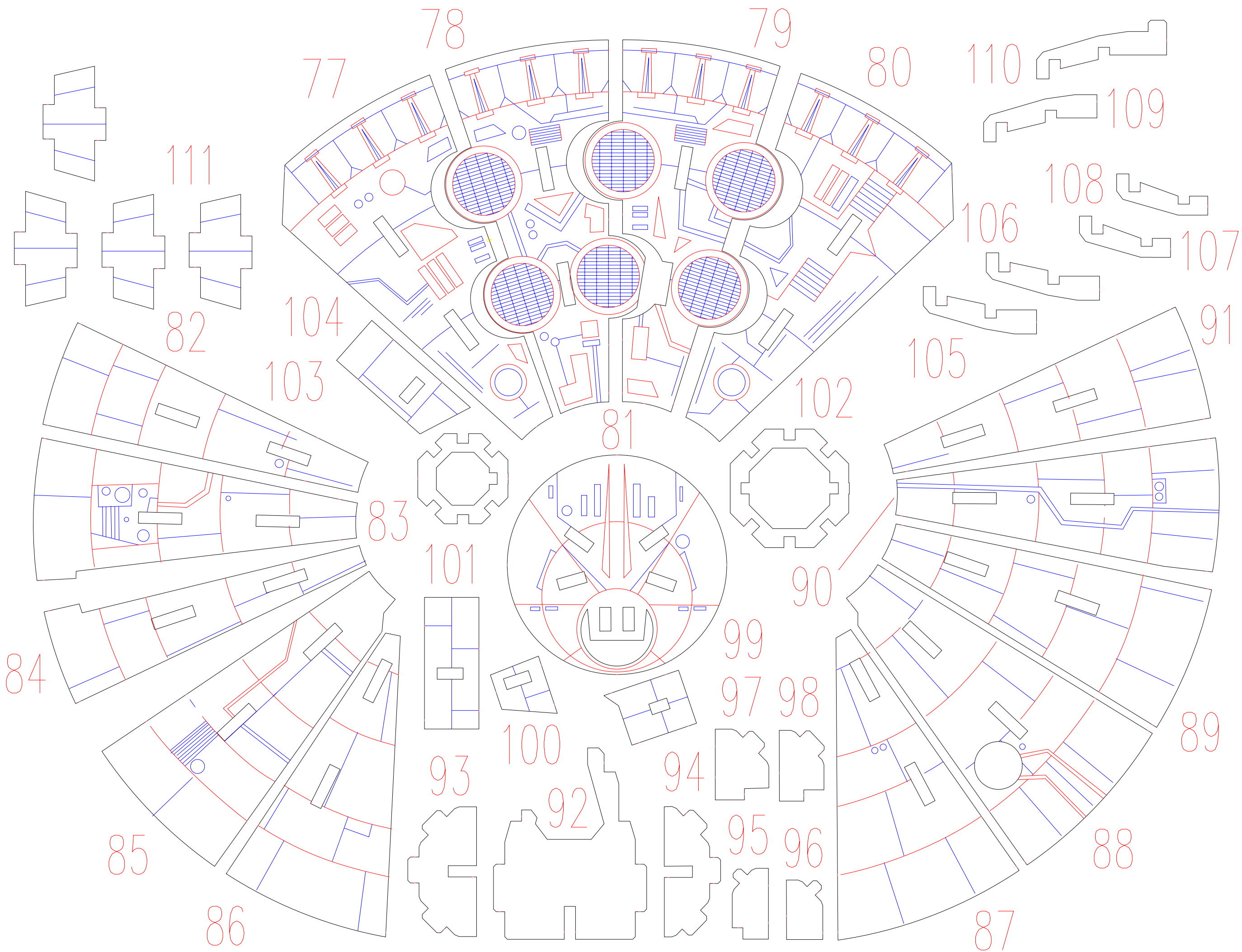

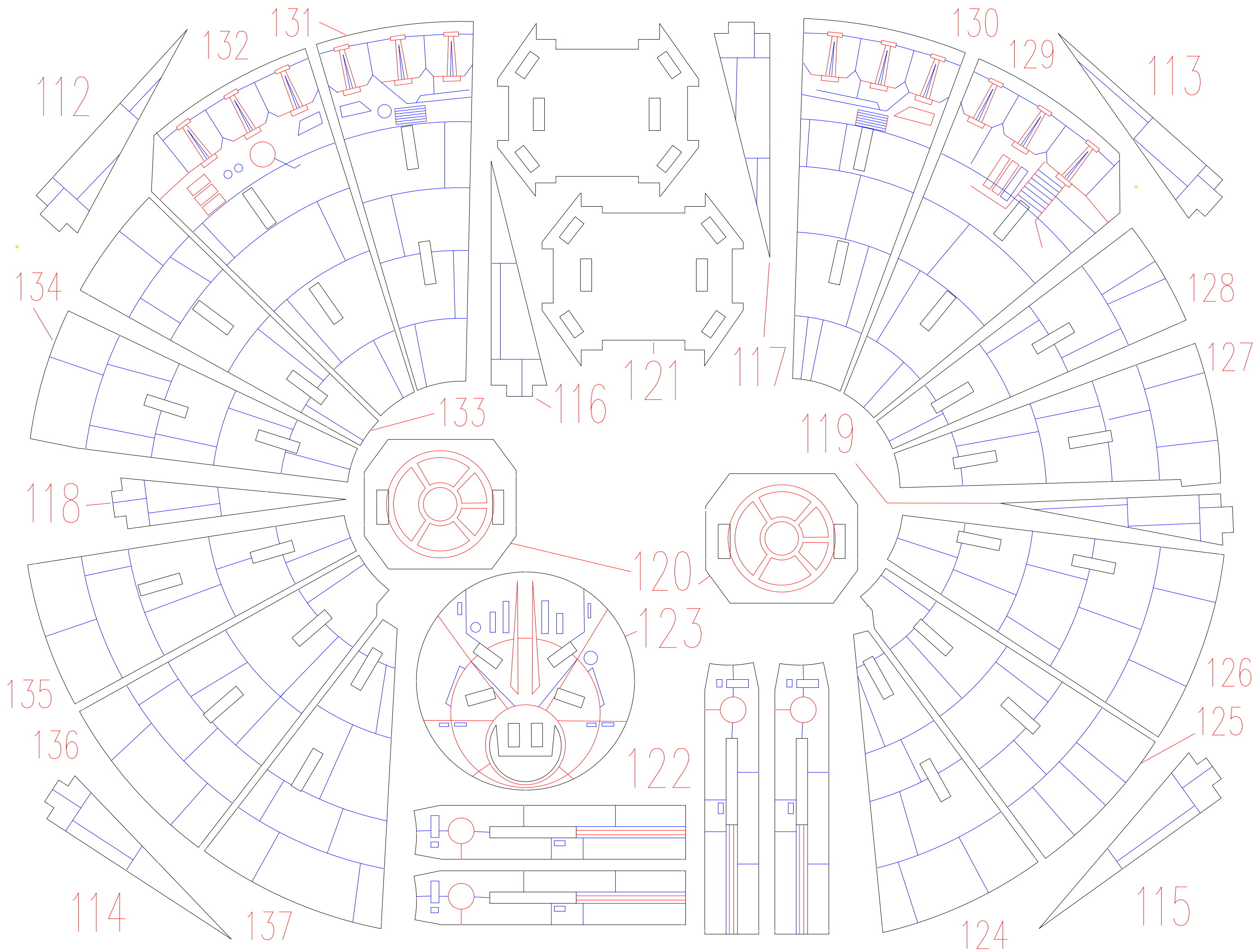

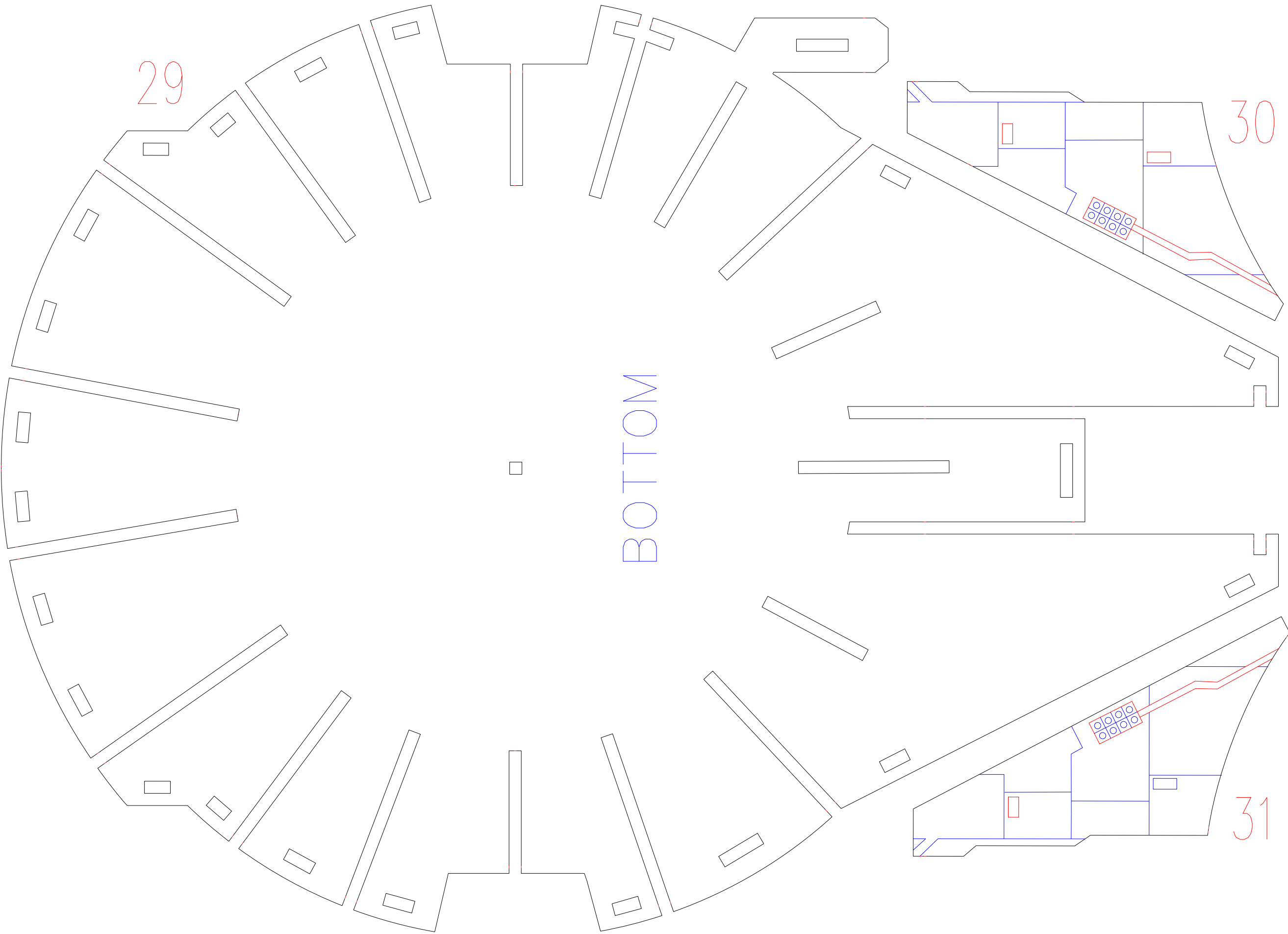

29

30

BOTTOM

31