

ITEM NO.	PART NUMBER	DESCRIPTION	QTY.
1	Clock 26-Back Frame	Wood 12mm thk	1
2	Clock 26-Front Frame	Wood 12mm thk	1
3	Clock 26-Frame Spacer	Wood	2
4	Clock 26-Escape wheel	Wood 9mm thk	1
5	Clock 26-Gears-60 Teeth	Wood 9mm thk	4
6	Clock 26-Gears-38 Teeth	Wood 9mm thk	1
7	Clock 26-Gears-32 Teeth	Wood 9mm thk	1
8	Clock 26-Gears-30 Teeth	Wood 9mm thk	1
9	Clock 26-Gears-20 Teeth	Wood 9mm thk	1
10	Clock 26-Gears-15 Teeth	Wood 9mm thk	1
11	Clock 26-Dial	Wood 9mm thk	1
12	Clock 26-Hour Gears-30 Teeth	Wood 8mm thk	1
13	Clock 26-Hour Gears-32 Teeth	Wood 8mm thk	1
14	Clock 26-Hour Gears-10 Teeth	Wood 8mm thk	1
15	Clock 26-Hour Gears-8 Teeth	Wood 8mm thk	1
16	Clock 26 Hour Hand	Plastic	1
17	Clock 26 Minute Hand	Plastic	1
18	Clock 26-Dial Spacer	Wood	2
19	Gear spacer - long	Wood	1
20	Clock 26-Spacer 12mm	Wood	2
21	Clock 26-Release	Wood 12mm Thk	1
22	Clock 26 Sprocket- 12-2	Plastic 2mm Thk	3
23	Clock 26-Chain Guide	Wood 8mm thk	4
24	Clock 20-Drum	Wood	1
25	Clock 20-Ratchet	Wood 8mm thk	1
26	Clock 26 Winder shaft spacer	Wood	1
27	Clock 26-Winder Spacer	Wood	1
28	Clock 26 Winder Shaft-Pawl	Wood 9mm thk	3
29	Clock 24-Pendulum Pivot Block	Wood 9mm thk	1
30	Clock 24-Pendulum Bob	Wood and Brass	1
31	Clock 24-Pendulum Lock	Wood 6mm thk	1
32	Clock 24-Pendulum Rod	Carbon Fibre Ø6xØ4x1150mm	1
33	Clock 26-Gravity Arm	Wood 9mm thk	1
34	Clock 26-Gravity arm top spacer	Wood	1
35	Clock 26-Spacer 12mm	Wood	1
36	Clock 26-Shaft Sleeve-6	Wood	1
37	Winder Shaft	Brass Ø8 x 140	1
38	Clock 26-Lifting Lever	Wood 9mm thk	1
39	Clock 24-Weight Anchor	Wood 12mm thk	1
40	Clock 24-Weight Tube Insert	Wood 9mm thk	1
41	Clock 24-Weight Tube	Plastic Tube Ø68x2	1
42	Weight - End Plug	Wood 9mm thk-nut recess	1
43	Clock 26-winder back stop Pawl	Wood 9mm thk	1
44	Clock 26-Trigger	Wood 9mm thk	1
45	Clock 26-Remontoire Pawl	Wood 9mm thk	1
46	Clock 26-Brace	Wood 9mm thk	1
47	Clock 26-Wall Spacer	Wood 9mm thk	3
48	Clock 26-Frame Spacer Small	Wood 9mm thk	1
49	Clock 26 Bearing Plug Large	Wood	1
50	Clock 26 Bearing Plug	Wood	11
51	Clock 26-Spacer 2	Wood	2
52	Clock 26-Spacer 31	Wood	1
53	Clock 26-winder backstop	Wood 8mm thk	1
54	Clock 26-Pendulum pivot	Steel Ø6x 68 mm	1
55	Clock 26-Lever arm Stop	Steel Ø3 x 18	1

ITEM NO.	PART NUMBER	DESCRIPTION	QTY.
56	Nut 6mm	M6 nut	2
57	Clock 24-Threaded rod-weight	Stainless Steel M6	1
58	Clock 26 Hour Gear Pivot	Steel	2
59	Clock 24-Headed Pin 1	Steel	1
60	Clock 26-Main Shaft	Steel Ø4 x 150	1
61	Clock 26-Shaft 112	Steel Ø4 x 112	5
62	Clock 26-Pinx22	Silver Steel Ø2 x 22	15
63	Clock 26-Sprocket Pin-34	Steel Ø2 x 34	2
64	Clock 24-Winder Pawl Pivot	Steel-headed pin	3
65	Clock 24-Winder Pawl Stop	Steel Ø3 x 18	3
66	Clock 26-Pendulum impulse Pin	Steel Ø4 x 70	1
67	Domed nut-m6	Brass	6
68	M6 Washer	Brass or Delrin	6
69	Threaded rod-m6	Steel Threaded rod Ø6 x 130	3
70	Clock 26-Weight Cord	Blind Cord Ø1mm	1
71	Bearing 6-10-3	MR106ZZ	4
72	Clock 20-Bearing Ø4mmxØ10mmx4mm	MR104ZZ	12
73	Clock 26-woodscrew-long	Brass C/Snk	3
74	Clock 26-Headed Pin 53	Steel	1
75	Clock 26-Headed Pin 24	Steel	2
76	Clock 26-Stop pin-24	Steel Ø1.5 x 24	1
77	Clock 26-Stop pin-52	Steel Ø1.5 x 52	1
78	Clock 23-Bearing 8mm	Ø8mmxØ14mmx4mm	2
79	Clock 26-Dial support pin	Steel Ø4 x 27	2
80	Clock 26-Hour Gear Sleeve	Wood	1
81	Chain 50-LPF	Chain 50 links per foot	1
83	Clock 26-Escapement Weight-2	Wood and Brass	1
84	Clock 26-Roller	Wood	1
85	Clock 26-Pinx13	Silver Steel Ø2	1
86	Clock 26-Catch	Wood	1
89	Clock 26-Gears-12 Teeth	Wood 8mm thk	1
90	Clock 26-Sprocket Pin	Steel Ø2 x 37mm	2

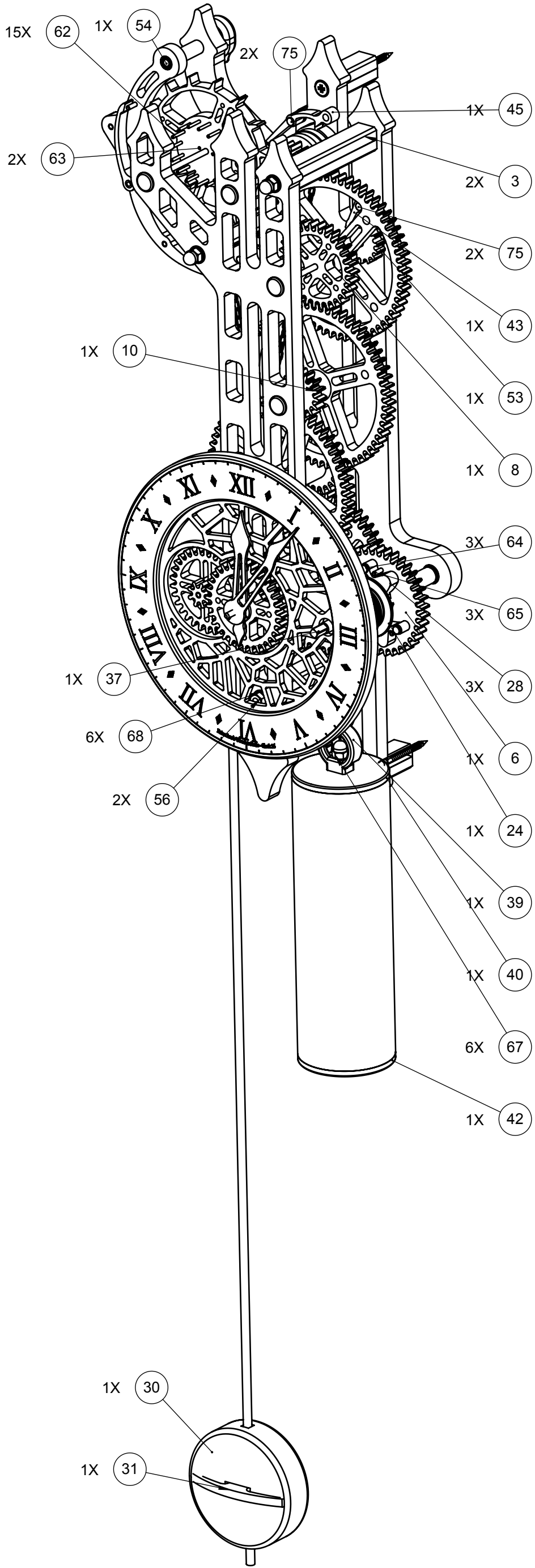

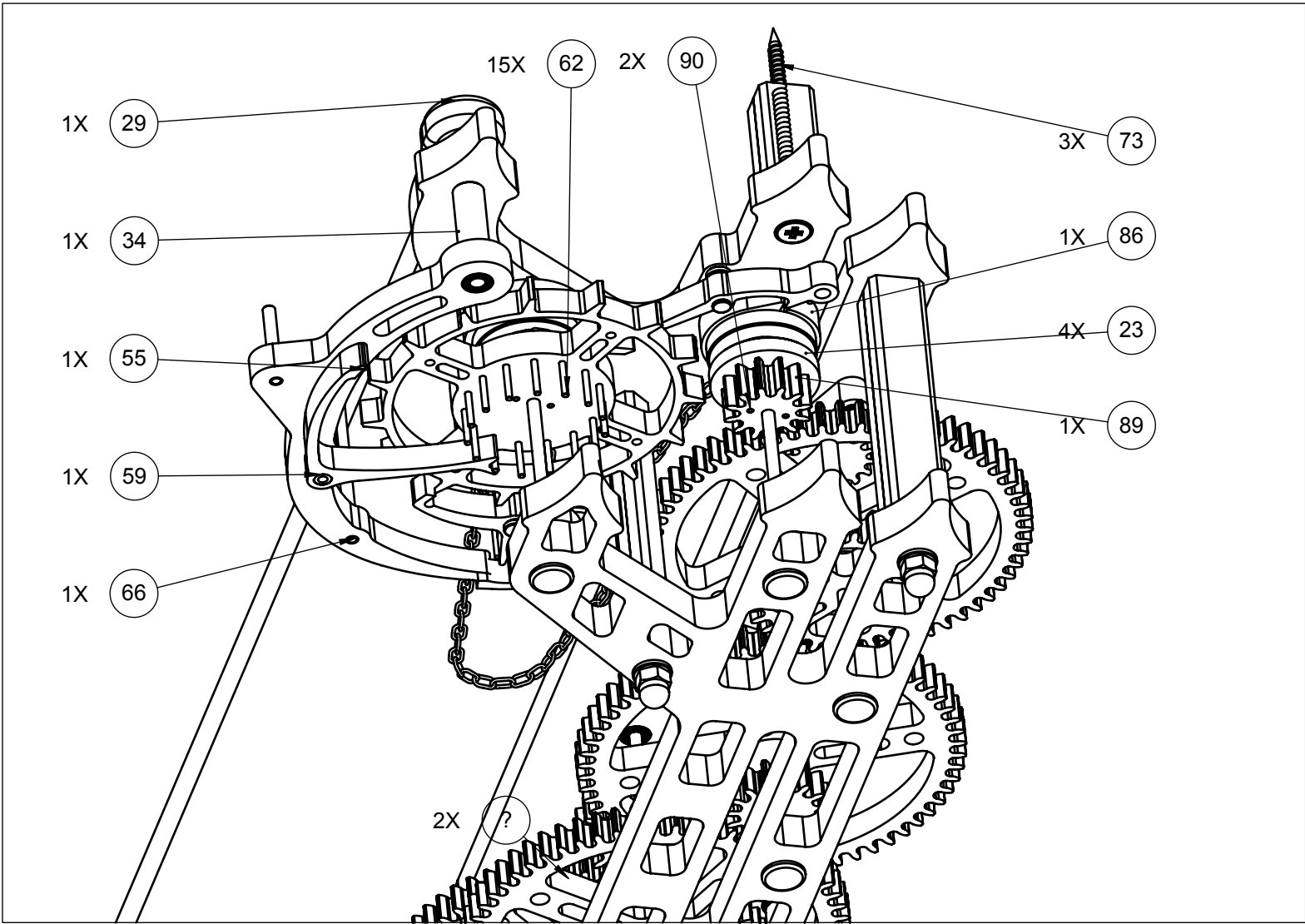
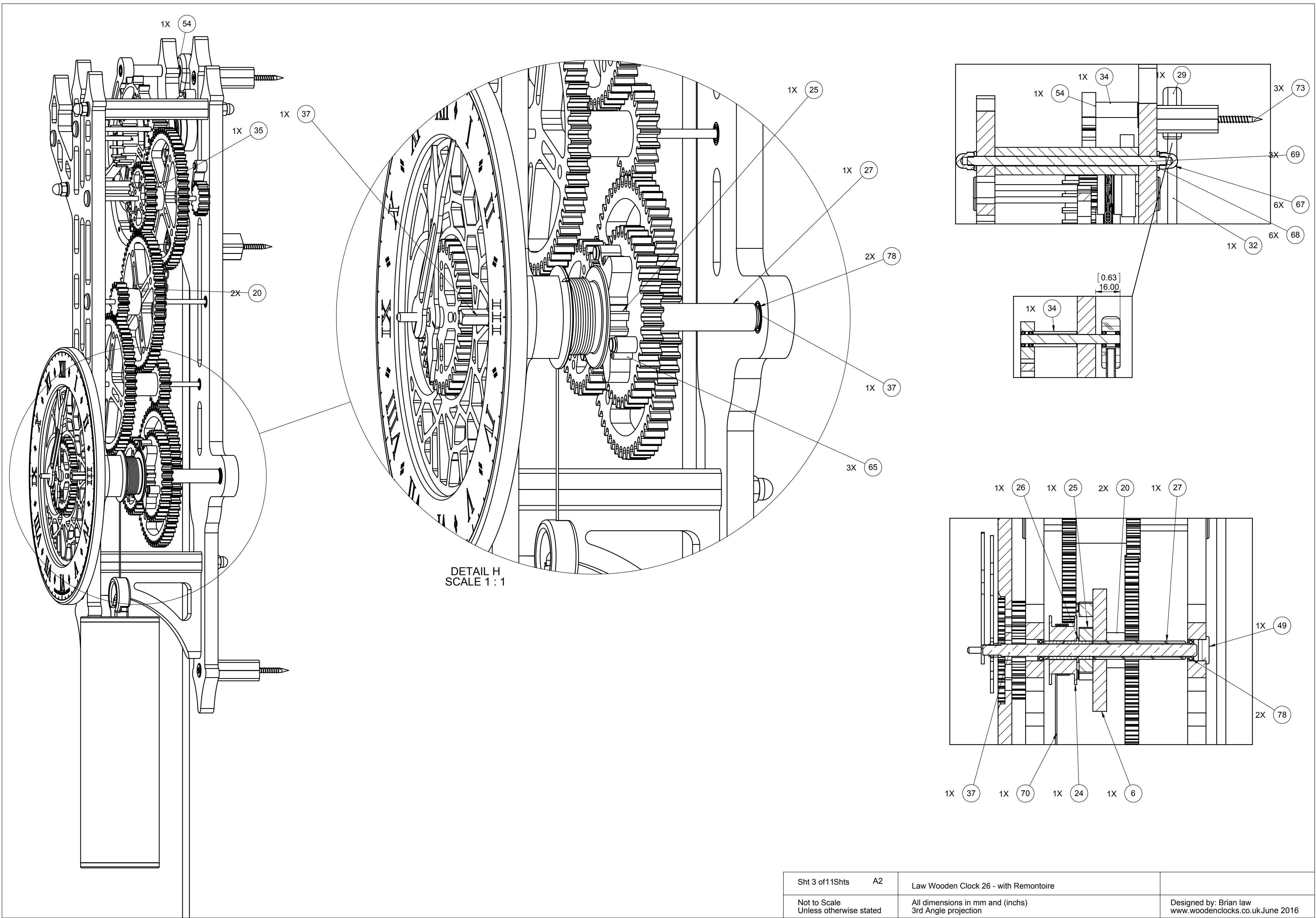

Sht 3 of 11Shts	A2	Law Wooden Clock 26 - with Remontoire	
Not to Scale Unless otherwise stated		All dimensions in mm and (inches) 3rd Angle projection	Designed by: Brian law www.woodenclocks.co.uk June 2016

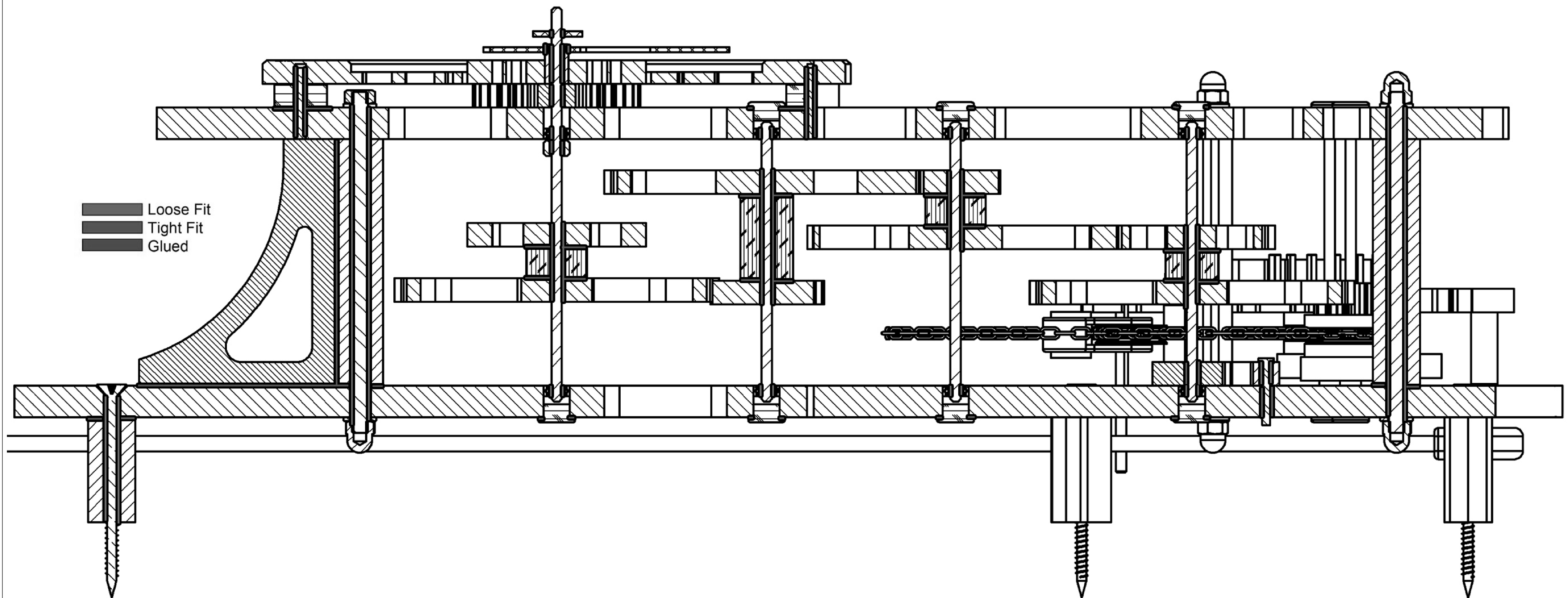

Sht 4 of 11 Shts	A2	Law Wooden Clock 26 - with Remontoire	
Not to Scale Unless otherwise stated		All dimensions in mm and (inches) 3rd Angle projection	Designed by: Brian law www.woodenclocks.co.uk June 2016

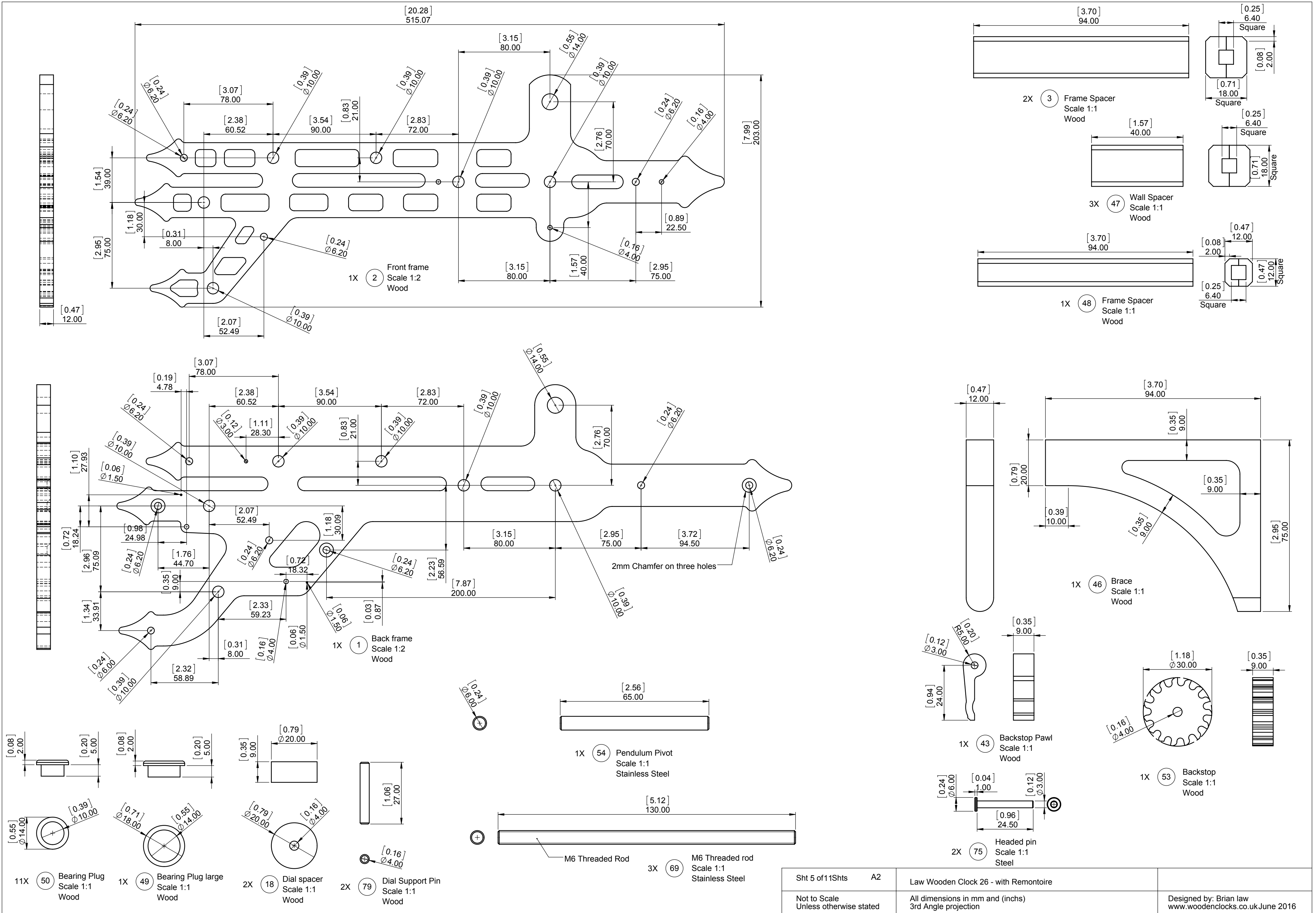

Sht 5 of 11Shts	A2	Law Wooden Clock 26 - with Remontoire	
Not to Scale Unless otherwise stated		All dimensions in mm and (inches) 3rd Angle projection	Designed by: Brian law www.woodenclocks.co.uk June 2016

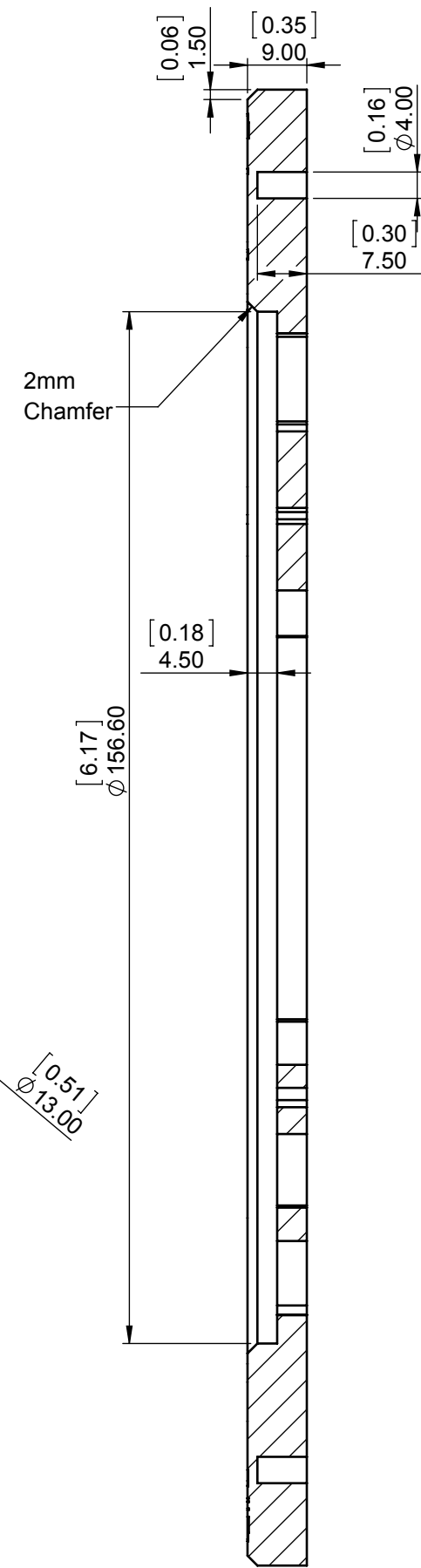
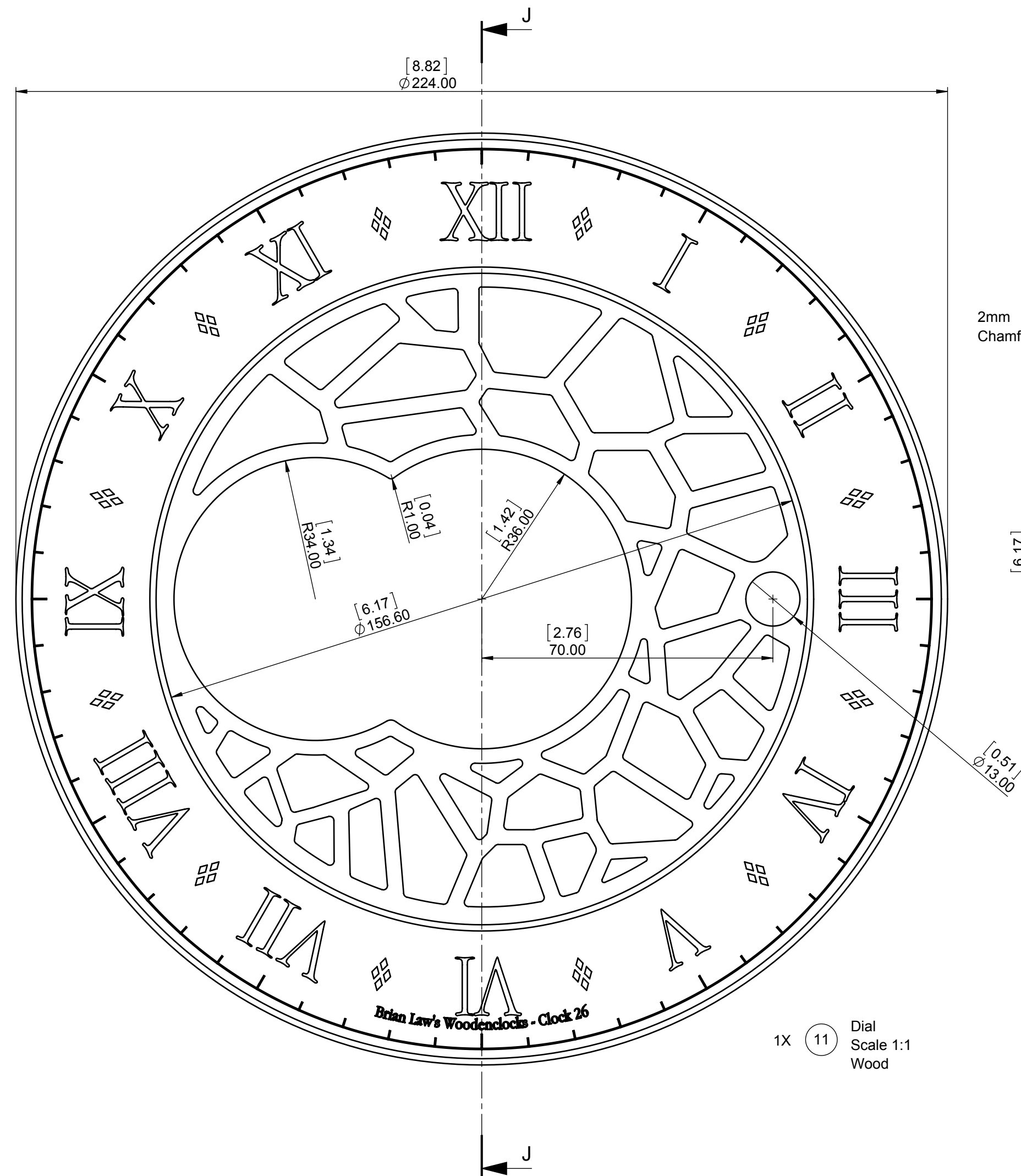

SECTION J-J
SCALE 1 : 1

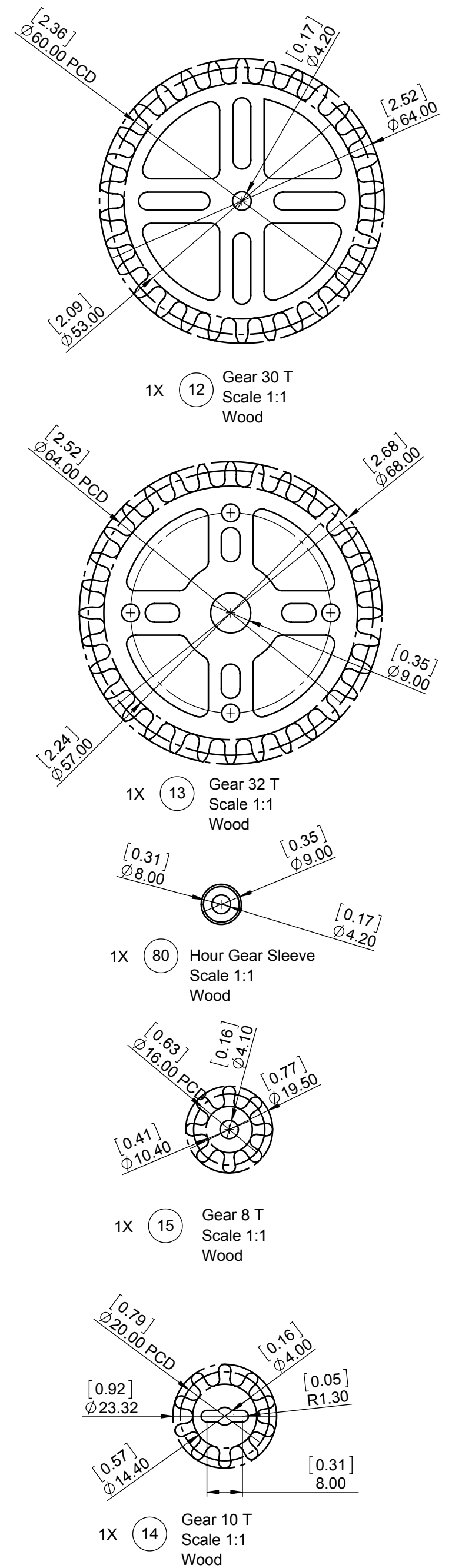
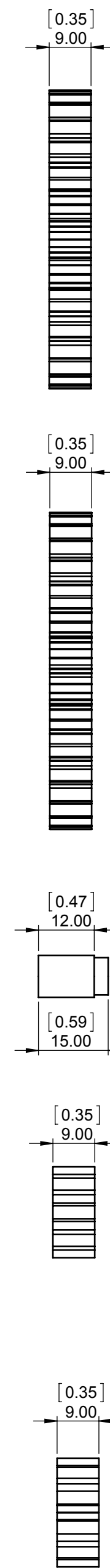
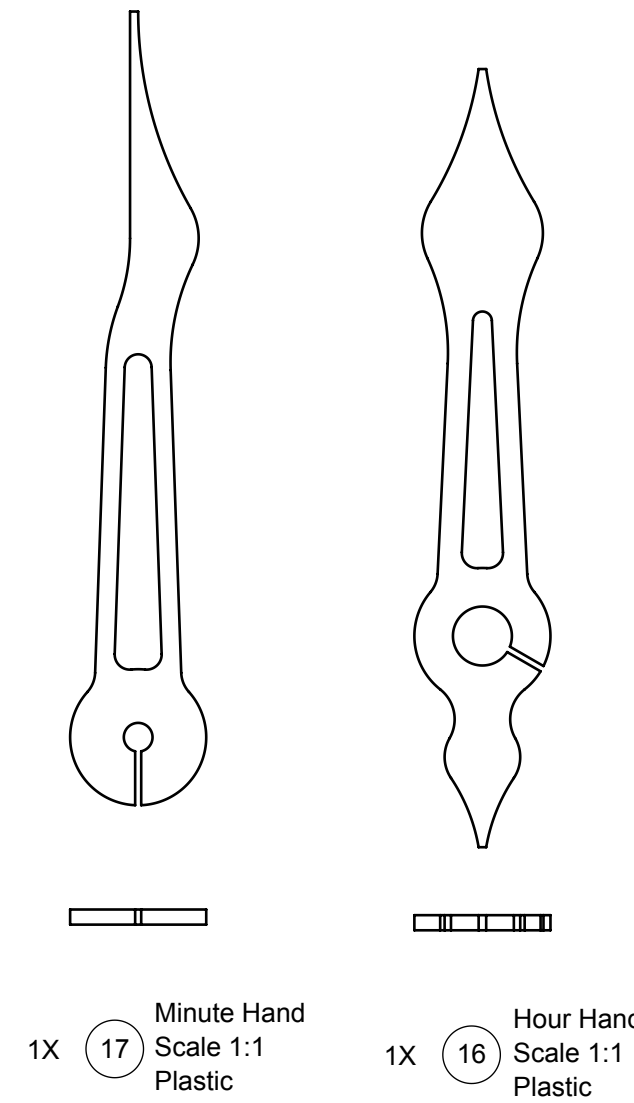

Sht 6 of 11Shts	A2	Law Wooden Clock 26 - with Remontoire	
Not to Scale Unless otherwise stated		All dimensions in mm and (inches) 3rd Angle projection	Designed by: Brian law www.woodenclocks.co.uk June 2016

Winder Shaft Assembly

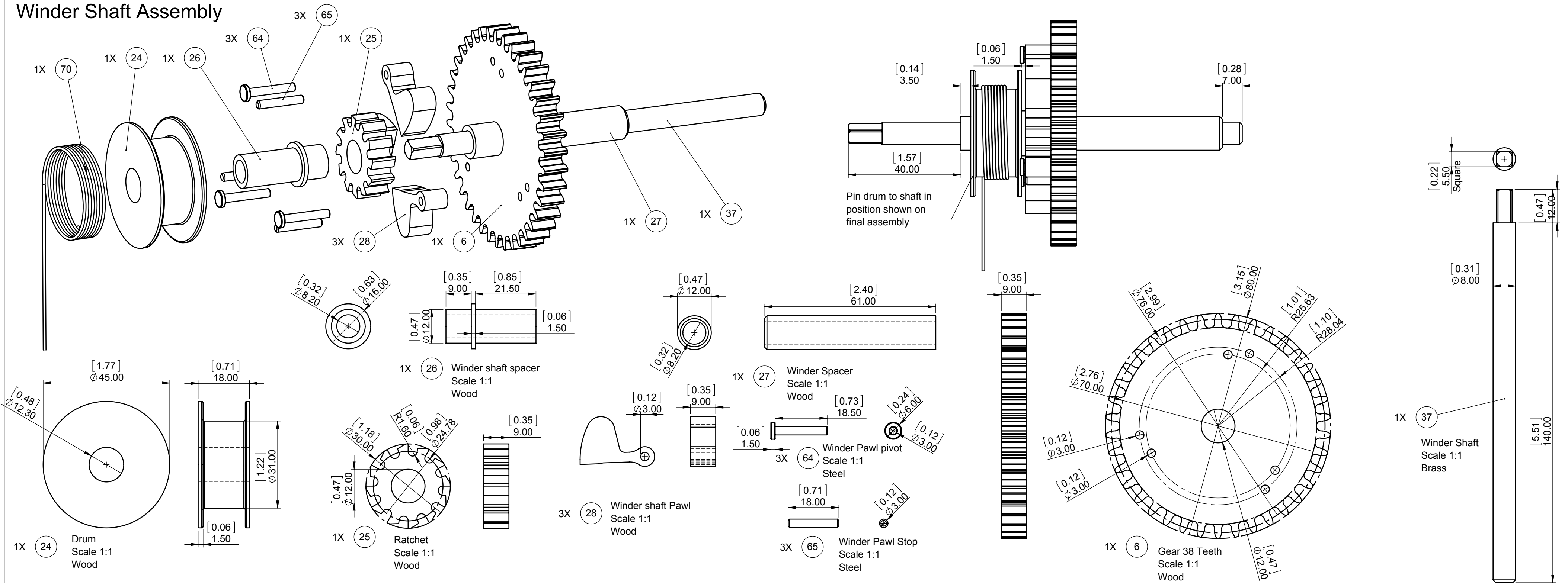

Drive Shaft Locking

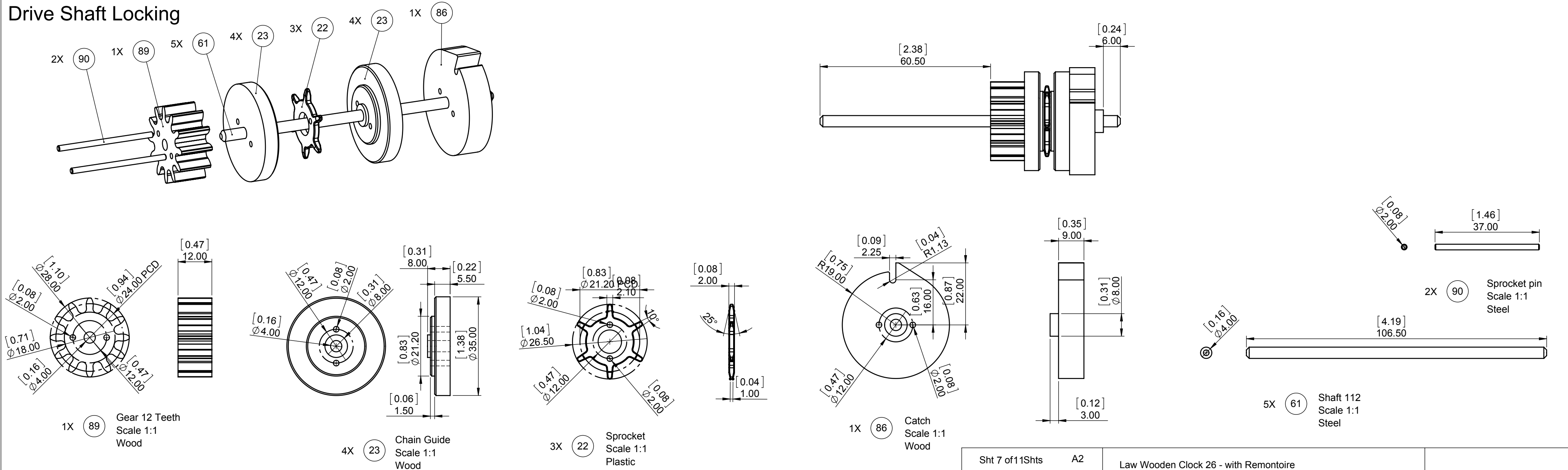

Sht 7 of 11 Shts A2	Law Wooden Clock 26 - with Remontoire	
Not to Scale Unless otherwise stated	All dimensions in mm and (inches) 3rd Angle projection	Designed by: Brian law www.woodenclocks.co.uk June 2016

Note Chain Guides sprockets and shaft drawn on Sheet 7

1X 4 Escape Wheel
Scale 1:1
Wood

15X 62 Pin 22mm
Scale 1:1
Steel

2X 63 Sprocket Pin 34
Scale 1:1
Steel

1X 21 Release
Scale 1:1
Wood

Technical drawing of a mechanical assembly, showing multiple views and dimensions. The drawing includes a perspective view of the assembly, a top view of the gear assembly, a side view of the gear assembly, and a cross-section view of the gear assembly.

Assembly Components and Dimensions:

- 1X (7)**: Gear 32 Teeth, Scale 1:1, Wood. Dimensions: [1.99] 50.50, [1.00] 25.50, [1.50] 38.00.
- 1X (60)**: Gear 60 teeth, Scale 1:1, Wood. Dimensions: [0.35] 9.00, [4.72] $\phi 120.00$ PCD, [4.88] $\phi 124.00$, [4.47] $\phi 113.60$, [0.16] $\phi 4.00$.
- 2X (20)**: Gear spacer 23 dia, Scale 1:1, Wood. Dimensions: [0.16] $\phi 23.00$, [0.91] $\phi 23.00$, [0.47] 12.00.
- 4X (5)**: Main Shaft, Scale 1:1, Steel. Dimensions: [0.24] 6.00, [0.39] $\phi 10.00$, [0.16] $\phi 4.00$.
- 1X (36)**: Shaft Sleeve, Scale 1:1, Wood. Dimensions: [0.24] 6.00, [0.39] $\phi 10.00$, [0.16] $\phi 4.00$.
- 1X (7)**: Gear 32 Teeth, Scale 1:1, Wood. Dimensions: [2.68] $\phi 68.00$, [2.24] $\phi 57.00$, [0.16] $\phi 4.00$, [2.52] $\phi 64.00$ PCD.
- 4X (5)**: Gear 60 teeth, Scale 1:1, Wood. Dimensions: [0.16] $\phi 4.00$, [0.16] $\phi 4.00$.
- 1X (60)**: Main Shaft, Scale 1:1, Steel. Dimensions: [5.91] 150.00.

Sht 8 of 11Shts	A2	Law Wooden Clock 26 - with Remontoire	
Not to Scale Unless otherwise stated		All dimensions in mm and (inches) 3rd Angle projection	Designed by: Brian law www.woodenclocks.co.uk June 2016

Gear Train 2

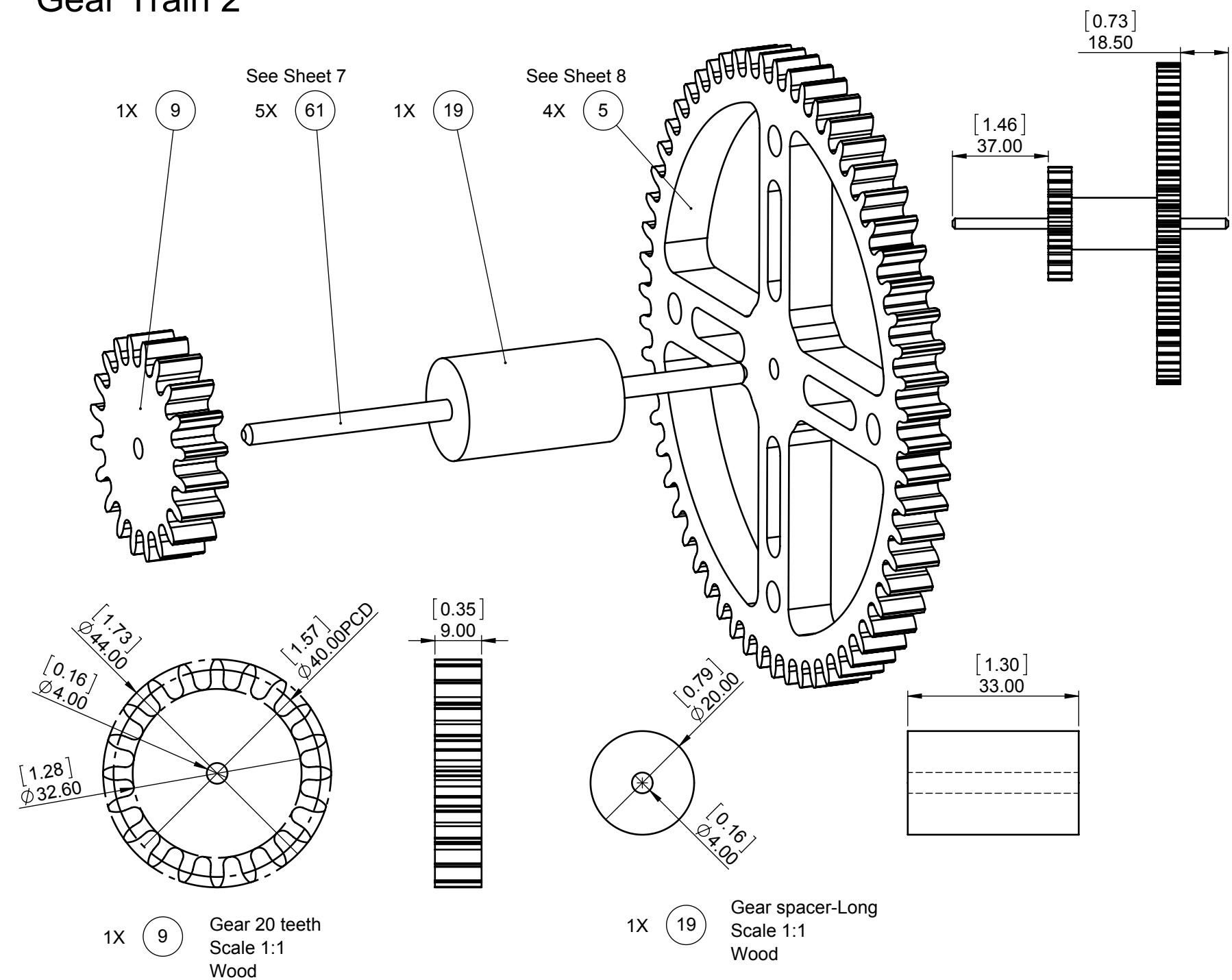

Gear Train 3

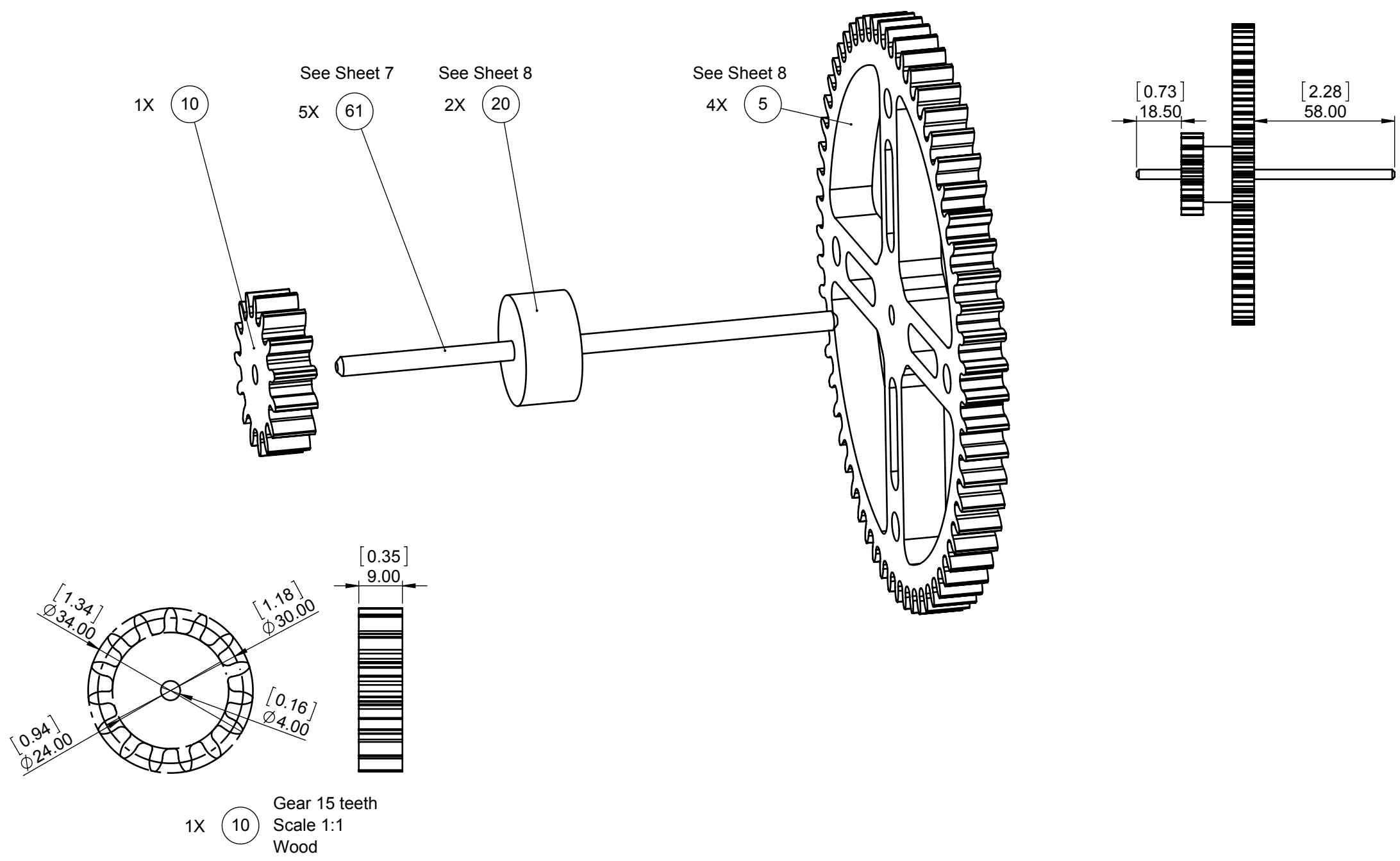

Gear Train 4

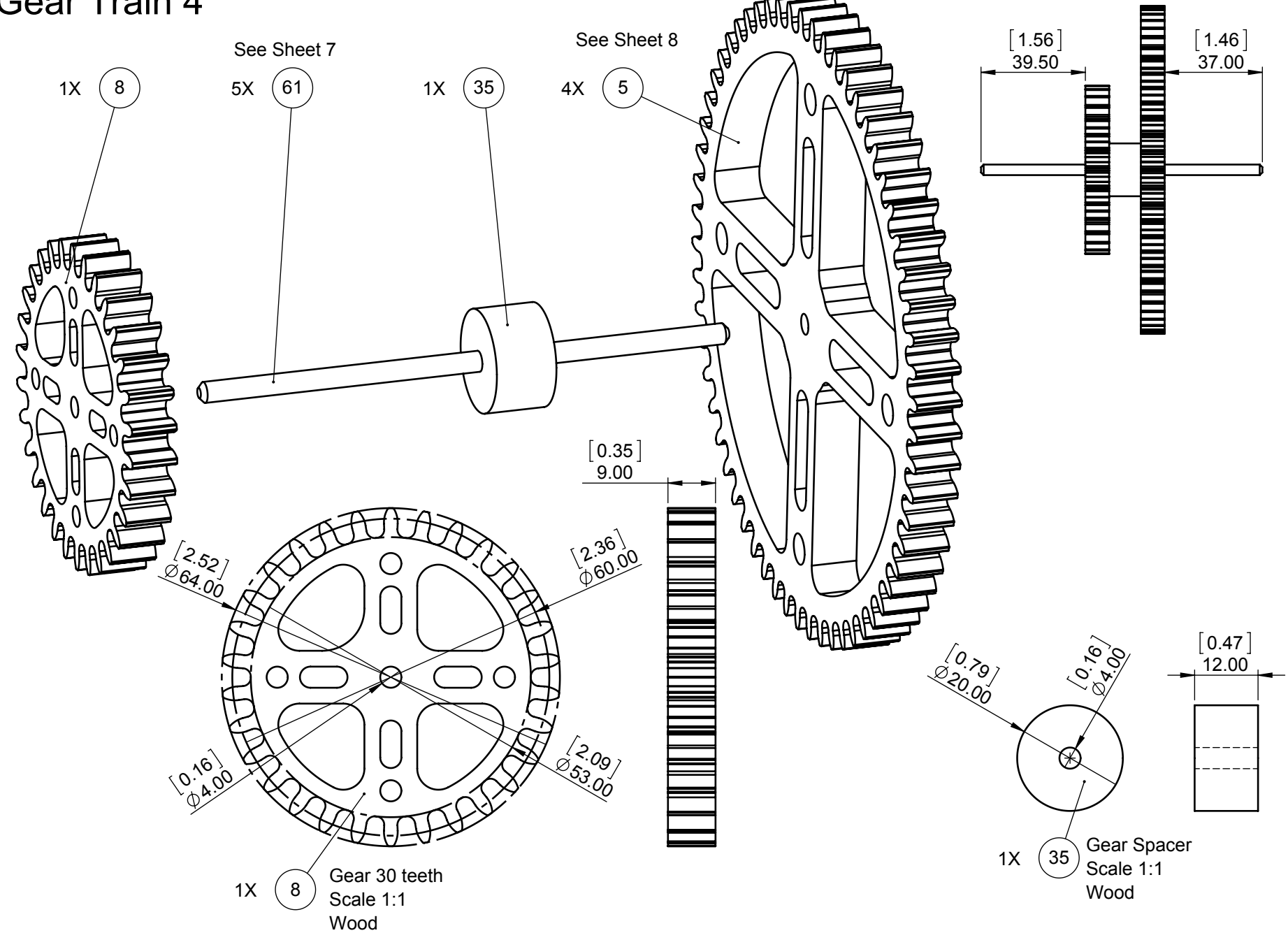

Chain Drive

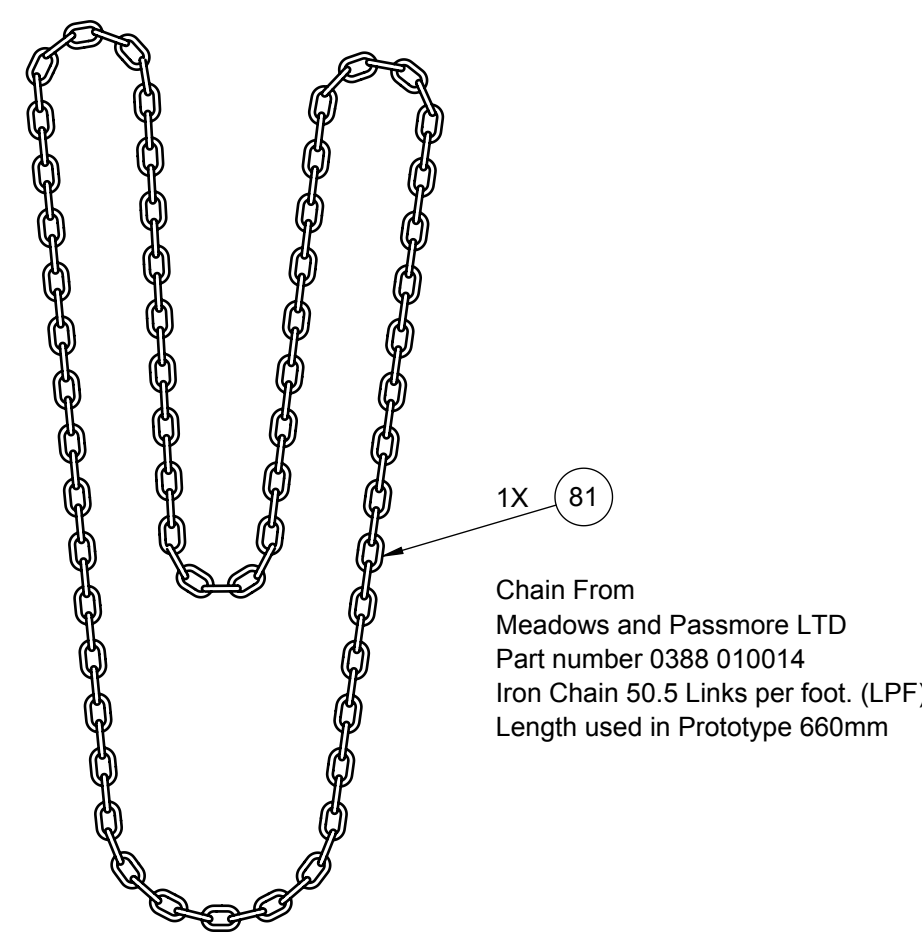

Sht 9 of 11Shts	A2	Law Wooden Clock 26 - with Remontoire	
Not to Scale Unless otherwise stated		All dimensions in mm and (inches) 3rd Angle projection	Designed by: Brian law www.woodenclocks.co.uk June 2016

Pendulum Assembly

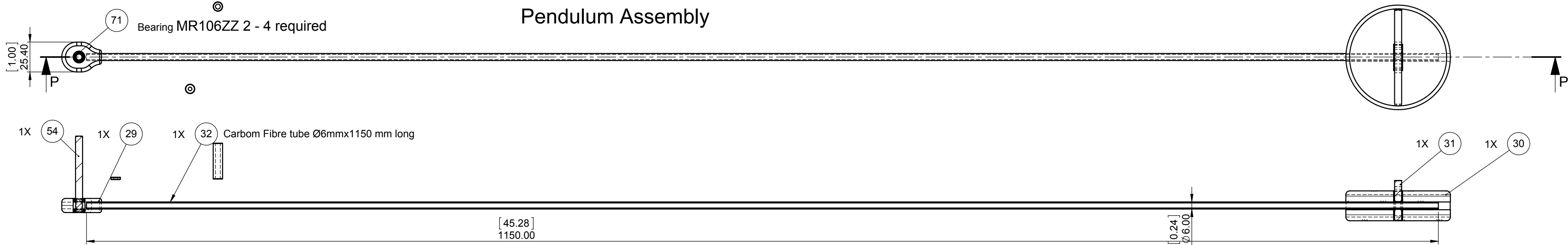

Main Weight Assembly

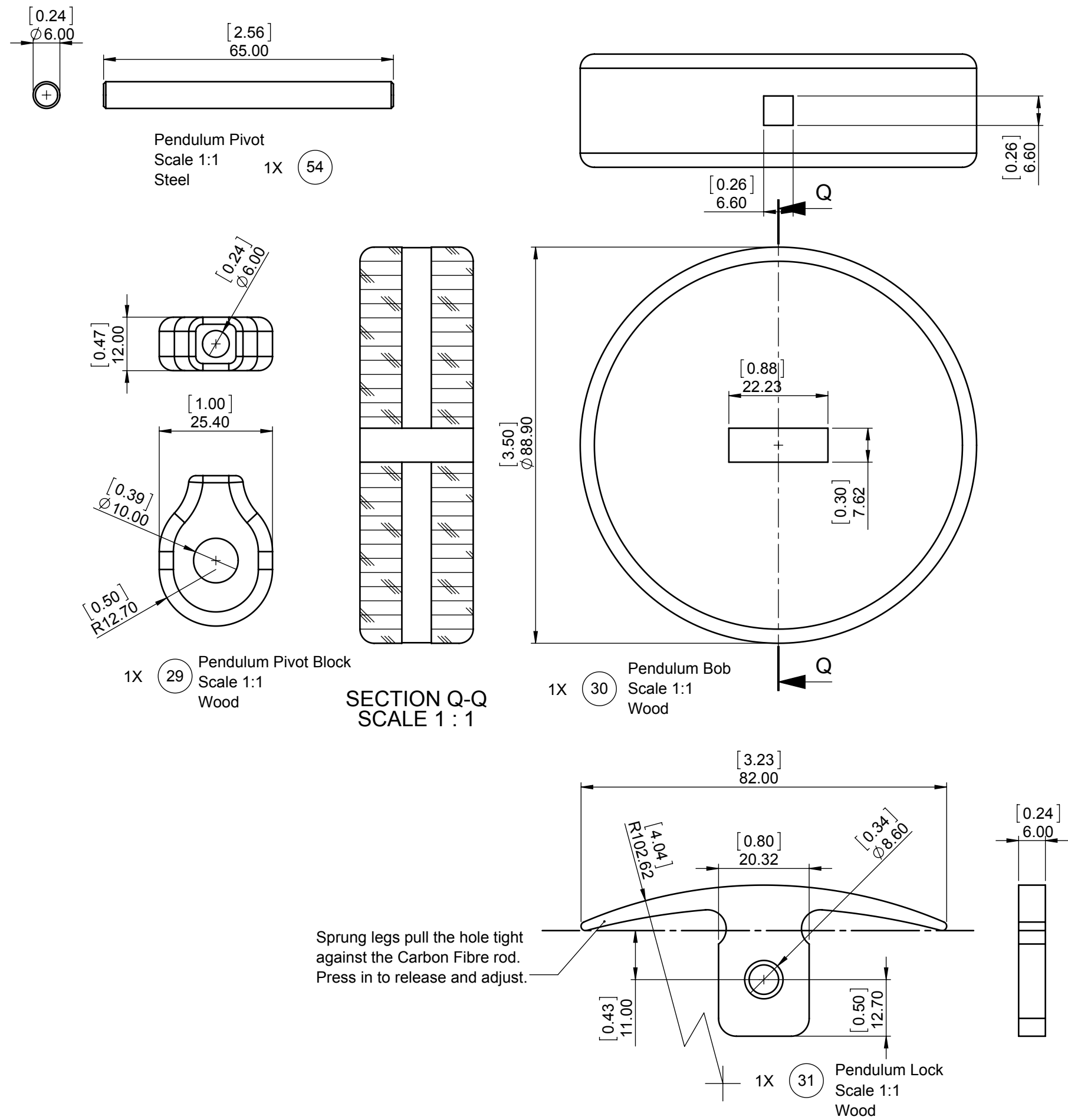
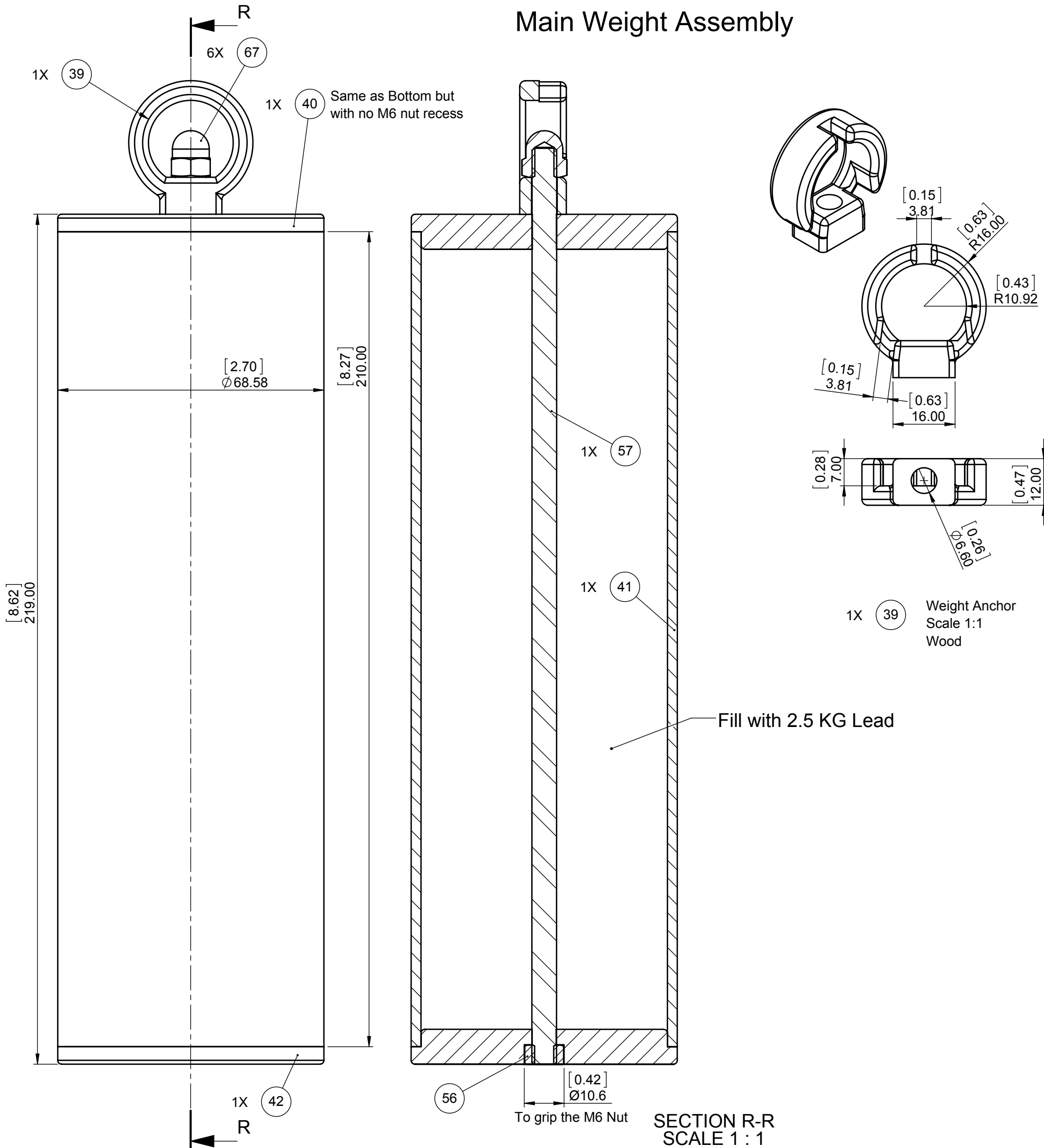

Sht10 of 11 Shts	A2	Law Wooden Clock 26 - with Remontoire	
Not to Scale Unless otherwise stated		All dimensions in mm and (inches) 3rd Angle projection	Designed by: Brian law www.woodenclocks.co.uk June 2016

Gravity Arm Assembly

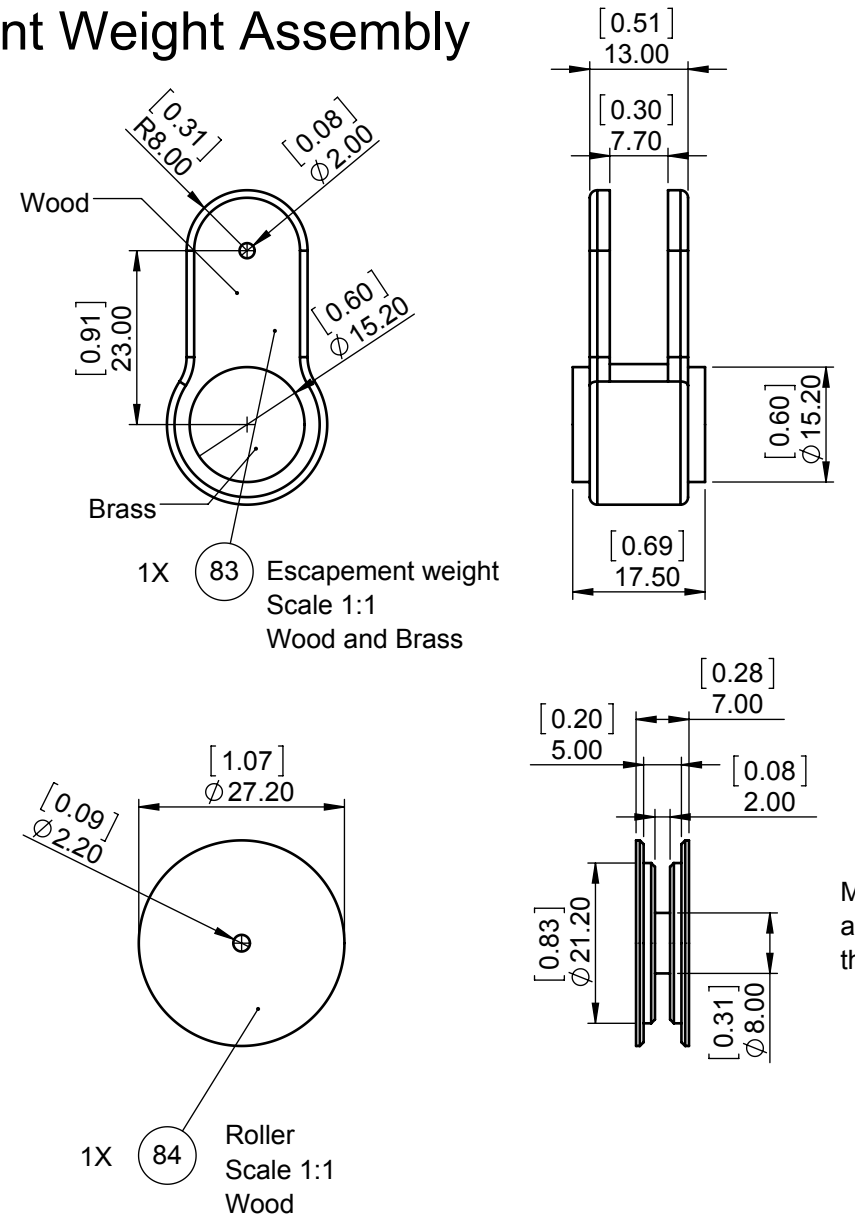
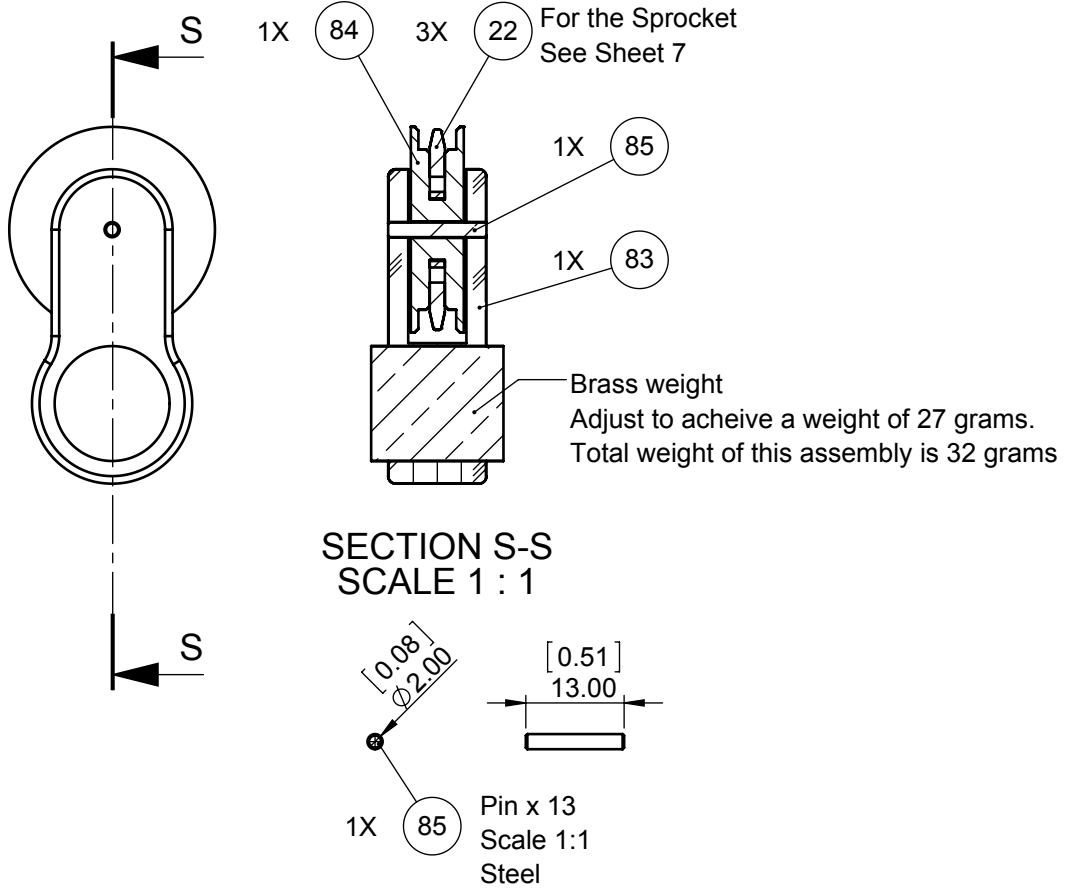
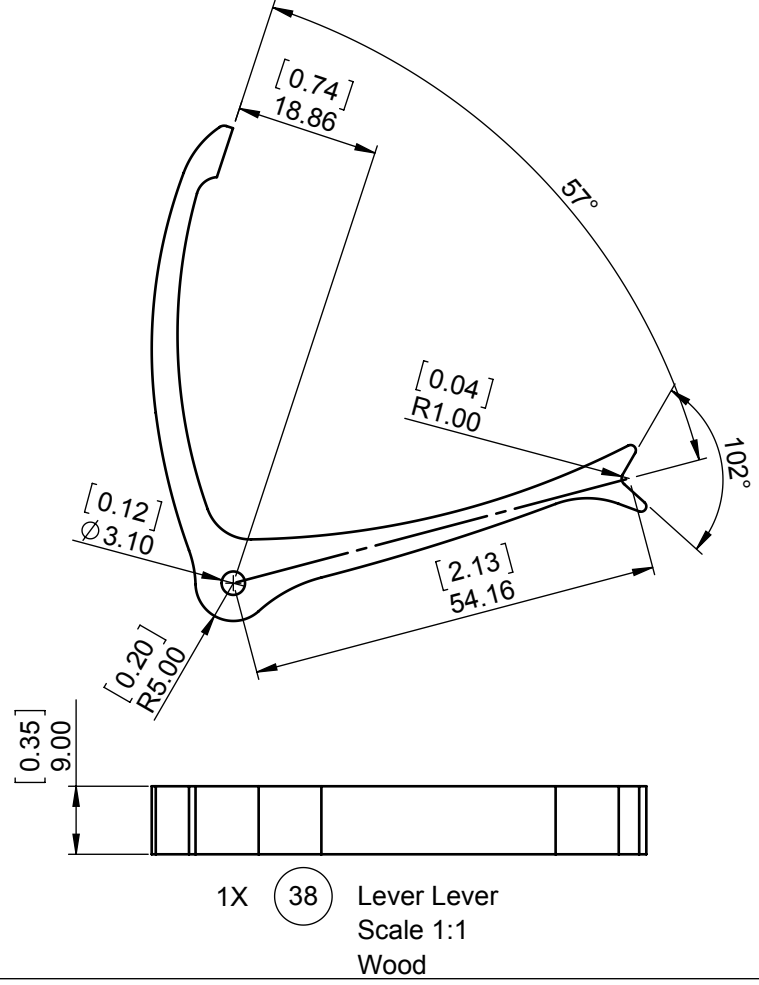
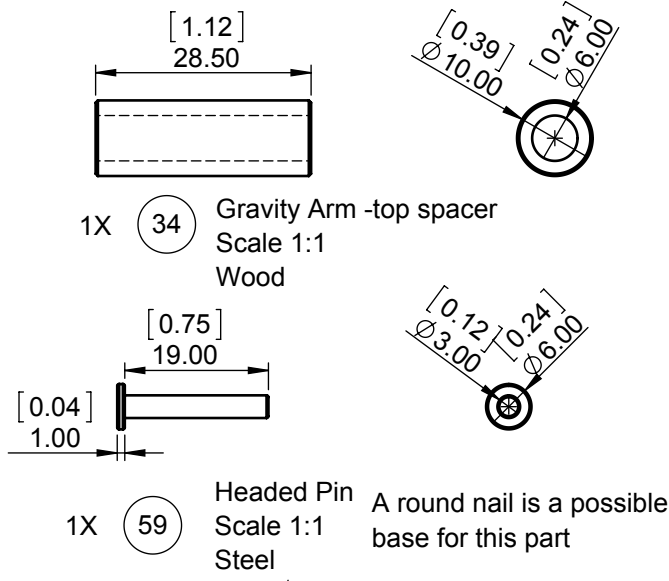
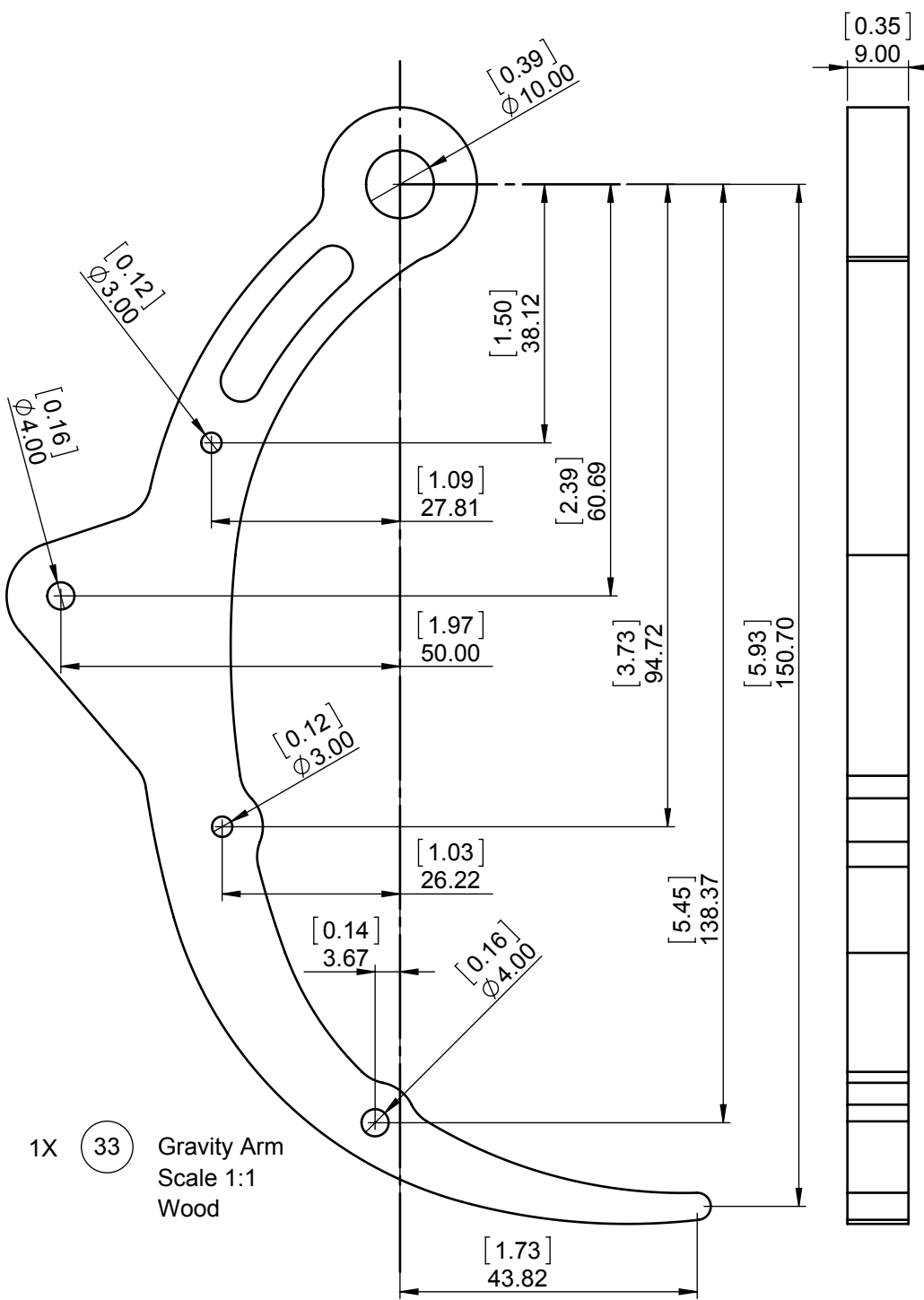
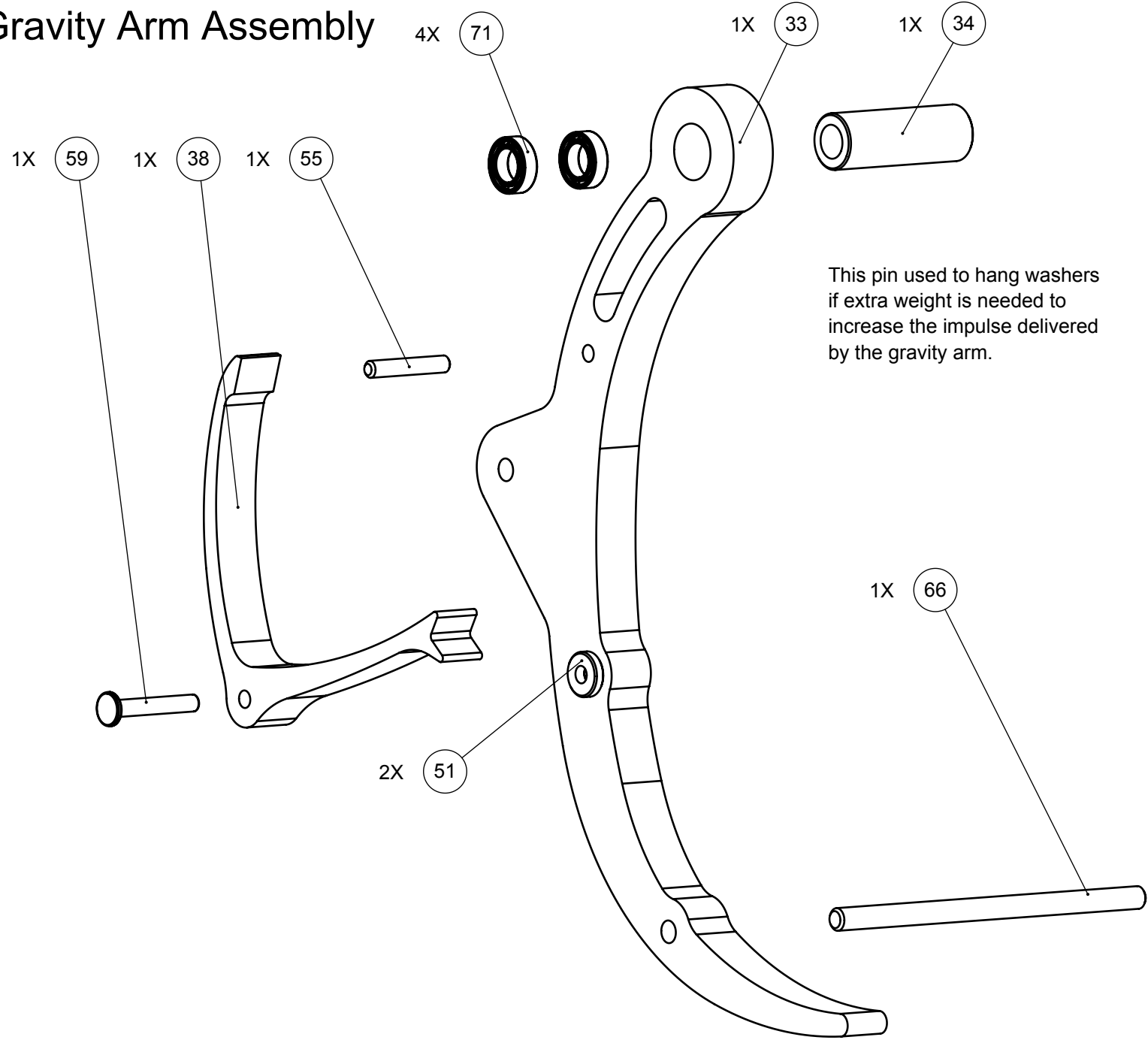

Trigger Assembly

